



2025 **SPORT** HORSE NATIONALS

23RD ANNUAL



NEW FOR 2025

- AHA/HA AA Western Dressage suitability and A/HA/AA Western Dressage Hack
- A/HA/AA The \$2,500 Greier School Hunter Derby are now National Championship classes

ADDED EXHIBITION CLASSES:

- A/HA/AA Western Dressage Basic Level Junior Horse Championship
- A/HA/AA Working Hunter ATR 2' Chammpionship
- A/HA/AA Working Hunter 2'6' Exhibition





ARABIAN HORSE ASSOCIATION

Performance Futurity/Maturity/Derby

ANYONE CAN DREAM - ANYONE CAN WIN / #DREAMBIGWINBIG

[ArabianHorses.org/competition/prize-money-programs/performance/](https://arabianhorses.org/competition/prize-money-programs/performance/)

ANYONE CAN DREAM—
ANYONE CAN WIN

Sport Horse Nationals

Performance Maturity PROGRAM

Arabian and Half-Arabian/Anglo-Arabians can compete in Performance Maturity Classes at the Sport Horse Nationals. A wonderful marketplace to showcase the best and brightest that the industry offers and earn prize money.

PERFORMANCE MATURITY CLASSES:

Five to Six-year-old: • **Arabian Sport Horse Under Saddle AOTR**
• **HA/AA Sport Horse Under Saddle AOTR**

Nomination into the Performance Maturity Program is required and must be made on the official nomination form. Enrollment into the program will serve as the qualification for the class. Nominations will be entered under the current recorded owner of the horse.

Nomination fee does not include show entry fees, post entry fees, drug fees, stall fees, etc. Nomination into the Performance Maturity Program does not constitute entry into the Sport Horse National Championship Show. A separate Sport Horse Nationals Show Entry form must be submitted with the appropriate entry fees prior to the First Post Entry Close in order for the horse to be shown in the specified Performance Maturity Class.

Nominations are allowed with the additional \$750 late fee up until the First Post Entry Close date for Sport Horse Nationals. Any Program enrollment fees (including late fees) must be paid.

NOTE: Half-Arabians competing in the Maturity Class must have parentage DNA verified to the purebred Arabian parent on file at the AHA office before the horse is allowed to compete.

For complete rules, enrollment fees and deadlines regarding the Performance Maturity Program, please refer to Chapter 20 of the current AHA Handbook.

2025 **SPORT** HORSE NATIONALS

FEES:

Class Entry Fees	\$250
Exhibition Class Entry Fee	\$125
Post Entry Fees > per horse (up to 8/20)	\$500
Late Class Post	\$100 / \$200
Education/Evaluation Fee > per horse (Res. 9-90)	\$25
Failure to Close Open Show Accounts	\$100
Hunter Warm-up (W) > per class	\$30
(included in class fee)	
Grounds fee > per horse	\$25

JACKPOT FEES

(J1) ABS AOTR Classes	\$500
(J2) SHN Jackpot	\$500
Office Fee > per horse	\$85
Non-Competing Horse Fee	\$435
(includes stall, office and per horse fee)	
Over Fences Schooling Fee	\$50
(Sunday 9/7 all day, per horse/rider combination)	
Returned checks/declined credit card fee	\$60
Late Scratch/Rider/Equitation Horse Fee	\$50
Scoring > per horse	\$15
USEF Fees > per horse (includes \$8 Admin & \$16 Drug)	\$23
USEF Show Pass	
Must be purchased online with USEF (Exhibitors in Amateur classes must join USEF, show pass is NOT acceptable)	
WDA Non-Member	\$55 Adult / \$40 Junior

STALLING

Patron/Elite Sponsors will receive stalling preferences. Please see the Preferred Stalling Section for complete details.

Horse stalls > each	\$250
Tack stalls > each	\$250

OPTIONAL ITEMS

Shavings per bag (subject to change)	\$12
Additional Show Program	\$10
Equine Services Permit	See form
Full Hook Up RV Space	\$500
Electric & Water RV Space	\$450

PATRONSHIPS/SPONSORSHIP

Platinum Patron	\$1,800
Gold Patron	\$1,500
Elite Sponsorship	\$1,100
Paddock Addition	\$600

EVENT SPONSORSHIP/PARTICIPATION

Arena Sign	\$400
Dressage Happy Hour > per night	\$1,500
Can be split between sponsors	
Class Sponsor	\$250
Class Garland Sponsor	
Champion & Reserve Garland	\$200
Champion Garland	\$135
Reserve Garland	\$65
Decoration & Flowers Sponsor	\$250
Welcome Party Sponsor	\$8,500
Can be split between sponsors	

Call AHA at (303) 696-4500 option #1 or
email NationalEvents@ArabianHorses.org for more
Sponsorship information

GENERAL INFORMATION:

SHOW OFFICE

Office Hours:

Saturday - Sunday, September 6 - 7	8:30 AM - 7 PM
Monday - Saturday, September 8 - 13 1/2 hr after the last class	

BARN OFFICE

Office Hours:

Thursday - Sunday, September 4 - 7	8 AM - 10 PM
Monday - Saturday, September 8 - 13	7 AM - 7 PM

FACILITY SHIPPING INFORMATION

Packages for the horse show will only be accepted from
Monday, September 8 thru Friday, September 12.

Neither AHA nor World Equestrian Center is responsible for
lost or stolen packages.

World Equestrian Center (Fed Ex/UPS only)

Attn: Arabian Sport Horse Nationals

(Person's name or company)

4095 OH-730, Wilmington, OH 45177

SHOW COMMISSION

Jim Porcher, Chair New Mexico |

Cricket Gates, Vice Chair Pennsylvania |

Debra Glasener Ohio |

Mike Moak Georgia |

Marilyn Weber Illinois |

Cara Phelps Missouri |

Show Commission can be contacted at:

Arabian Horse Association

Attn: SHN Show Commission

6030 Greenwood Village Blvd., Suite 100

Greenwood Village, CO 80111

Phone (303) 696-4500 • Fax (303) 696-4599

NationalEvents@ArabianHorses.org

www.ArabianHorses.org

JUDGES

The management reserves the right to vary or add to this list.
Panels and/or judge order are subject to change.

HUNTER/JUMPER

Sara Rhodes	IL
William Sparks	LA

DRESSAGE

Michell Combs	AZ
Lisa El-Ramey	FL
Dolly Hannon	CO
Michael Osinski	WA
Debbie Riehl-Rodriguez	CO
Dorie Vlaten-Schmitz	AZ

SPORT HORSE IN-HAND

DRESSAGE TYPE

Gwen Ka'awaloa	CO
Peter Hansen	DE

HUNTER TYPE

Danielle Ackley	SC
Phillip Long	NC

SPORT HORSE UNDER SADDLE (MOS)

HUNTER TYPE

Sara Rhodes	IL
William Sparks	LA

The Hunter/Jumper Judges will alternate.

DRESSAGE TYPE

Gwen Ka'awaloa	CO
(WD Rail classes)	
Peter Hansen	DE
Wayne Quarles	KY

EVENTING

Wayne Quarles KY |

DRIVING

Kail Palmer-Miller PA |

The judges were selected by the Judges & Stewards Selection Committee.



EVENT RULES & INFORMATION

All Entry Forms Available @ www.arabianhorses.org/nationalevents

OFFICIALS

NATIONAL EVENTS General email
NationalEvents@ArabianHorses.org

Executive Director

R. Stanton Morey ... (303) 696-4538
Stan.Morey@ArabianHorses.org

Director of Corporate & National Events & Marketing Senior Manager

Paige Lockard..... (720) 648-9220
Paige.Lockard@arabianhorses.org

National Events Coordinator

Elise Sosa..... (303) 696-4519
Elise.Sosa@ArabianHorses.org

National Show Secretary

Marlene Kriegbaum (303) 696-4501
Marlene.Kriegbaum@Arabian-Horses.org

Marketing & Branding Manager

Angie Higgins (303) 696-4580
Angelia.Higgins@ArabianHorses.org

Marketing Coordinator

Savana Linder (303) 696-4581
Savana.Linder@ArabianHorses.org

Media Communications Coordinator

Colby Rice..... (303) 696-4551
Colby.Rice@arabianhorses.org

Youth & Family Program Director

Brenna Johnson (303) 696-4505
Brenna.Johnson@ArabianHorses.org

Show Manager

..... Jim Porcher

Logistics Coordinator

..... Matt Kwapich

Grounds Manager

..... Matthew Amsden

USEF Stewards

..... Nancy Harvey
Joan Shelton-Palalek

Ring Stewards

..... Ron Gekiere
Alison Walk-Sheridan

Announcers

Hunter/Jumper Julie Gelderman

Sport Horse Andrew Bailey

Dressage Awards Julie Gelderman

Barn Manager

..... Dave Daugherty
(614) 989-2385
ddaughe1@insight.rr.com

Dressage Technical Delegate

..... Dianne Stanley

Dressage Coordinator

..... Carol Spangler

Carriage Coordinator

..... Matt Kwapich

Carriage Timer

..... Matthew Amsden

Farrier

..... Joe Proby (708) 673-9692

Hunter & Jumper Course Designer

..... Ken Okken

Photographer

..... Liz Crawley
www.lizcrawleyphotography.com

Veterinarian

..... Equine Athlete
Veterinary Services
Dr. Brad Hill (517) 643-1091

Web Live Streaming

..... USEF Network

IMPORTANT DEADLINES & DATES

ENTRY DEADLINE: Tuesday, JULY 29, Midnight (MT)

- Exhibitors are advised to use a form of expedited, traceable mail service when sending entries in order to ensure entries are received by AHA.
- **METERED MAIL** will only be accepted with an official postmark from a post office from the country of origin that indicated the location and date the Postal Service accepted custody of a mail piece and cancels affixed postage.

NO ENTRIES ACCEPTED AFTER Saturday, September 6 @ 5 PM Local time for any reason

POST ENTRIES DEADLINES

- **NO** New Horses, Dressage or Combined Training entries accepted after **Tuesday, August 12**
- Entries not received by the closing date may not be listed in the program. Every effort will be made to stall post entries with horses from the same barn.

NEW HORSES..... \$500 per Horse

- **Tuesday, July 29 thru Tuesday, August 12** (*New horses may be entered online*)
\$500.00 per horse if qualified for any class before Tuesday, July 29, including classes that do not require qualifications

ADDING CLASSES FOR HORSES ALREADY ENTERED

- Must be submitted on an entry form and waivers signed
- **Wednesday, July 30 thru Tuesday, August 12** – Regular class fee plus \$100.00 late class fee
- Added classes for Dressage tests or Combined Training will NOT be accepted after August 12.
- **Wednesday, August 13 thru Saturday, September 6 @ 5 PM Local Time**
Regular class fee plus \$200.00 late class fee – regardless of when qualified

ENTERING CLASSES NOT QUALIFIED BY THE CLOSING DATE

Horses and riders that enter by **Tuesday, July 29** but are not qualified for some class(es) but intend to qualify for the class(es) before the start of the National Show they are entering, **PLEASE** enter the non-qualified class(es) and pay the fees.

- Entering non-qualified class(es) by **July 29**, helps to determine if a class must be split and a revised schedule can be published before the start of the show. If you do not qualify for the class, the class fee will be refunded.
- Qualifications for classes can be earned up to the start of the show.
- When entering, please be aware of entering classes that might run in different rings at the same time. Every effort will be made to solve these conflicts, however rings will not be held for extensive periods to solve conflicts. Entry fees will be forfeited in case of time conflicts caused by two rings running simultaneously that can't be resolved.

STABLING & ARRIVAL INFORMATION

- Stabling requests must be received by **Tuesday, Aug. 12, Midnight (MT)**
- ONE form per group. and **MUST** list all owners and horses to be stabled together.
- **ARRIVAL – NO ARRIVAL is permitted prior to Thursday, Sept. 4, NOON**
- **DEPARTURE** – Stalls must be vacated by **Sunday, September 14, by 10 AM**
Past 10 AM SHARP, you will be billed the facility late departure fee of \$50.00 per hour per stall – *NO EXCEPTIONS

EXHIBITORS!

REMEMBER TO PICK UP YOUR AWARDS

They will NOT be mailed!





number CLASS

TOTAL FEE *per class****Arabian Breeders Sweepstakes Allocated Payback****SPORT HORSE IN-HAND**

- *1022..... ABS Arabian Yearling Sport Horse Filly In-Hand CH.....\$250
- *1023..... ABS Arabian Yearling Sport Horse Colt/Gelding In-Hand CH.....\$250
- *1024..... ABS HA/AA Yearling Sport Horse Filly In-Hand CH.....\$250
- *1025..... ABS HA/AA Yearling Sport Horse Colt/Gelding In-Hand CH.....\$250

YEARLINGS MUST BE ENROLLED AS BREEDING ENTRIES,
NO OTHER QUALIFICATIONS ARE REQUIRED FOR SPORT HORSE NATIONALS.
YEARLINGS MAY NOT CROSS ENTER INTO ATH OR OPEN (COMP 1203.1)

- *599..... Arabian 2 Year Old Sport Horse Colt In-Hand CH.....\$250
- *600..... Arabian 2 Year Old Sport Horse Gelding In-Hand CH.....\$250
- *601..... Arabian 2 Year Old Sport Horse Filly In-Hand CH.....\$250
- *1331..... HA/AA 2 Year Old Sport Horse Colt/Gelding In-Hand CH.....\$250
- *604..... HA/AA 2 Year Old Sport Horse Filly In-Hand CH.....\$250
- 1088..... Sport Horse In-Hand Juvenile Supreme Championship.....\$0

(Champions from all SH In-Hand Yearlings and 2 yr old classes may show in this class)

- 2701..... Arabian Sport Horse Mare In-Hand Hunter Type 3 & Over CH.....\$250
- 2709..... Arabian Sport Horse Mare In-Hand Hunter Type 3 & Over ATH CH.....\$250
- 2721..... Arabian Sport Horse Stallion In-Hand Hunter Type 3 & Over CH.....\$250
- 2729..... Arabian Sport Horse Stallion In-Hand Hunter Type 3 & Over ATH CH.....\$250
- 2741..... Arabian Sport Horse Gelding In-Hand Hunter Type 3 & Over CH.....\$250
- 2749..... Arabian Sport Horse Gelding In-Hand Hunter Type 3 & Over AT CH.....\$250
- 2761..... Arabian Sport Horse Mare In-Hand Dressage Type 3 & Over CH.....\$250
- 2769..... Arabian Sport Horse Mare In-Hand Dressage Type 3 & Over ATH CH.....\$250
- 2781..... Arabian Sport Horse Stallion In-Hand Dressage Type 3 & Over CH.....\$250
- 2789..... Arabian Sport Horse Stallion In-Hand Dressage Type 3 & Over ATH CH.....\$250
- 2801..... Arabian Sport Horse Gelding In-Hand Dressage Type 3 & Over CH.....\$250
- 2809..... Arabian Sport Horse Gelding In-Hand Dressage Type 3 & Over ATH CH.....\$250
- 2821..... HA/AA Sport Horse Mare In-Hand Hunter Type 3 & Over CH.....\$250
- 2829..... HA/AA Sport Horse Mare In-Hand Hunter Type 3 & Over ATH CH.....\$250
- 2861..... HA/AA Sport Horse Gelding In-Hand Hunter Type 3 & Over CH.....\$250
- 2869..... HA/AA Sport Horse Gelding In-Hand Hunter Type 3 & Over ATH CH.....\$250
- 2881..... HA/AA Sport Horse Mare In-Hand Dressage Type 3 & Over CH.....\$250
- 2889..... HA/AA Sport Horse Mare In-Hand Dressage Type 3 & Over ATH CH.....\$250
- 2921..... HA/AA Sport Horse Gelding In-Hand Dressage Type 3 & Over CH.....\$250
- 2929..... HA/AA Sport Horse Gelding In-Hand Dressage Type 3 & Over ATH CH.....\$250
- 485..... HA/AA Sport Horse Stallion In-Hand CH.....\$250
- 1026..... A/HA/AA Sport Horse In-Hand Supreme Champion.....\$0

(Champions from all Sport Horse In-Hand 3 & Over classes may show in this class)

New Classes OR Changes For 2025 Are Shaded

* / Sweepstakes Allocated Payout

**CLASS ABBREVIATIONS**

ATR = Amateur to Rider — all agesAATR = Adult Amateur to Rider

AOTR = Amateur Owner to Ride — all agesAAOTR = Adult Amateur Owner to Ride

number	CLASS	TOTAL FEE per class
--------	-------	---------------------

SPORT HORSE SHOWMANSHIP

1696..... A/HA/AA Sport Horse Showmanship ATH Champion (Quals waived)\$250

SHN SPORT HORSE IN-HAND 3 YR OLD JACKPOT EXTRA FEE

1721..... SHN Arabian Sport Horse In Hand 3 yr old Jackpot - Mare.....J2\$750

1722..... SHN Arabian Sport Horse In Hand 3 yr old Jackpot - GeldingJ2\$750

1723..... SHN Arabian Sport Horse In Hand 3 yr old Jackpot - StallionJ2\$750

1991..... SHN HA/AA Sport Horse In Hand 3 yr old Jackpot - MareJ2\$750

1992..... SHN HA/AA Sport Horse In Hand 3 yr old Jackpot - Gelding/StallionJ2\$750

ARABIAN BREEDERS SWEEPSTAKES JACKPOT EXTRA FEE

* 1505..... ABS Arabian Sport Horse Under Saddle AOTR Jackpot (7+ Yr old)J1.....\$750

* 1506..... ABS HA/AA Sport Horse Under Saddle AOTR Jackpot (7+ yrs old)J1.....\$750

Open to Sweepstakes Breeding or Original Entries 7 & overJ1 - ABS SH US Jackpot fee @ \$500J2 - SHN SH-IH 3 yr old Jackpot fee @ \$500**SPORT HORSE UNDER SADDLE**

2680..... Arabian Sport Horse Under Saddle Hunter Type CH.....\$250

2684..... Arabian Sport Horse Under Saddle Dressage Type CH.....\$250

2682..... Arabian Sport Horse Under Saddle Hunter Type ATR CH\$250

2686..... Arabian Sport Horse Under Saddle Dressage Type ATR CH\$250

1551..... Arabian Sport Horse Under Saddle AOTR Hunter Type CH.....\$250

1552..... Arabian Sport Horse Under Saddle AOTR Dressage Type CH.....\$250

1679..... Arabian Sport Horse Under Saddle Junior Horse Hunter Type CH.....\$250

1678..... Arabian Sport Horse Under Saddle Junior Horse Dressage Type CH\$250

2688..... HA/AA Sport Horse Under Saddle Hunter Type CH.....\$250

2692..... HA/AA Sport Horse Under Saddle Dressage Type CH.....\$250

2690..... HA/AA Sport Horse Under Saddle ATR Hunter Type CH.....\$250

2694..... HA/AA Sport Horse Under Saddle ATR Dressage Type CH.....\$250

1553..... HA/AA Sport Horse Under Saddle AOTR Hunter Type CH.....\$250

1554..... HA/AA Sport Horse Under Saddle AOTR Dressage Type CH.....\$250

1767..... HA/AA Sport Horse Under Saddle Junior Horse Hunter Type CH\$250

1766..... HA/AA Sport Horse Under Saddle Junior Horse3e Dressage Type CH\$250

SHOW HACK

348..... Arabian Sport Horse Show Hack CH\$250

352..... Arabian Sport Horse Show Hack ATR CH.....\$250

1051..... HA/AA Sport Horse Show Hack CH\$250

1055..... HA/AA Sport Horse Show Hack ATR CH\$250

New Classes OR Changes For 2025 Are Shaded**J1** / ABS Jackpot Fee @ \$500**J2** / ABS Jackpot Fee @ \$500

*Grey highlight indicates changes for 2025



number CLASS

TOTAL FEE *per class***CARRIAGE PLEASURE DRIVING**

1228	A/HA/AA Carriage Pleasure Driving Working CH.....	\$250
1232	A/HA/AA Carriage Pleasure Driving Turnout CH.....	\$250
1236	A/HA/AA Carriage Pleasure Driving Reinsmanship CH.....	\$250
1248	A/HA/AA Carriage Pleasure Driving Drive & Ride CH.....	\$250
1272	A/HA/AA Carriage Pleasure Driving Scurry Obstacle CH.....	\$250
1297	A/HA/AA Carriage Pleasure Driving Pick Your Route Obstacle CH.....	\$250
1281	A/HA/AA Carriage Pleasure Driving Double Jeopardy.....	\$250
1285	A/HA/AA Carriage Pleasure Driving Reverse Psychology CH.....	\$250
1322	A/HA/AA Carriage Pleasure Driving Timed Obstacle CH.....	\$250

DRESSAGE ENGLISH

1401	Arabian Dressage Training Level CH.....	\$250
1400	Arabian Dressage Training Level Junior Horse CH.....	\$250
1402	Arabian Dressage Training Level AAOTR CH.....	\$250
1403	Arabian Dressage Training Level ATR CH.....	\$250
1501	HA/AA Dressage Training Level CH.....	\$250
1404	HA/AA Dressage Training Level Junior Horse CH.....	\$250
1502	HA/AA Dressage Training Level AAOTR CH.....	\$250
1503	HA/AA Dressage Training Level ATR CH.....	\$250
1411	Arabian Dressage First Level CH.....	\$250
1405	Arabian Dressage First Level AAOTR CH.....	\$250
1406	Arabian Dressage First Level ATR CH.....	\$250
1511	HA/AA Dressage First Level CH.....	\$250
1407	HA/AA Dressage First Level AAOTR CH.....	\$250
1408	HA/AA Dressage First Level ATR CH.....	\$250
1421	Arabian Dressage Second Level CH.....	\$250
1409	Arabian Dressage Second Level AAOTR CH.....	\$250
1410	Arabian Dressage Second Level ATR CH.....	\$250
1521	HA/AA Dressage Second Level CH.....	\$250
1412	HA/AA Dressage Second Level AAOTR CH.....	\$250
1413	HA/AA Dressage Second Level ATR CH.....	\$250
1414	Arabian Dressage Third Level CH.....	\$250
1416	Arabian Dressage Third Level ATR CH.....	\$250
1417	HA/AA Dressage Third Level CH.....	\$250
1419	HA/AA Dressage Third Level ATR CH.....	\$250
1420	Arabian Dressage Fourth Level CH.....	\$250
1424	HA/AA Dressage Fourth Level CH.....	\$250

New Classes OR Changes For 2025 Are Shaded

* / Sweepstakes Allocated Payout



EVENT RULES & INFORMATION

All Entry Forms Available @ www.arabianhorses.org/nationalevents

number	CLASS	TOTAL FEE per class
828	A/HA/AA Dressage Fourth Level ATR CH.....	\$250
883	A/HA/AA Dressage Prix St. George CH.....	\$250
887	A/HA/AA Dressage Intermediate I CH.....	\$250
888	A/HA/AA Dressage Intermediate II CH.....	\$250
889	A/HA/AA Dressage Grand Prix CH.....	\$250
1427	A/HA/AA Dressage Prix St. George ATR CH.....	\$250
*1504	ABS A/HA/AA Dressage Prospect Incentive.....	\$250
	<u>*Open to only Sweepstakes Breeding or Original Entries</u>	

DRESSAGE WESTERN

2518	A/HA/AA Western Dressage Suitability (Quals waived)	\$250
2418	A/HA/AA Western Dressage Hack (Quals waived).....	\$250
2316	Arabian Western Dressage Basic Level CH	\$250
1573	Arabian Western Dressage Basic Level ATR CH	\$250
2317	HA/AA Western Dressage Basic Level CH.....	\$250
1574	HA/AA Western Dressage Basic Level ATR CH	\$250
2304	A/HA/AA Western Dressage Basic Level Jr Horse.....	\$250
3217	Arabian Western Dressage Level 1 CH.....	\$250
3218	Arabian Western Dressage Level 1 ATR CH	\$250
3219	HA/AA Western Dressage Level 1 CH.....	\$250
3220	HA/AA Western Dressage Level 1 ATR CH.....	\$250
2502	A/HA/AA Western Dressage Level 2 CH.....	\$250
2514	A/HA/AA Western Dressage Level 2 ATR CH.....	\$250
2552	A/HA/AA Western Dressage Level 3 CH.....	\$250
2571	A/HA/AA Western Dressage Level 4 CH.....	\$250

HUNTER HACK

361	Arabian Hunter Hack CH (2'6").....	\$250
365	Arabian Hunter Hack ATR CH (2'3").....	\$250
366	Arabian Hunter Hack AAOTR CH (2'3").....	\$250
368	Arabian Hunter Hack Junior Horse CH (2'3")	\$250
767	HA/AA Hunter Hack CH (2'6")	\$250
771	HA/AA Hunter Hack ATR CH (2'3").....	\$250
772	HA/AA Hunter Hack AAOTR CH (2'3").....	\$250
765	HA/AA Hunter Hack Junior Horse CH (2'3")	\$250

WORKING HUNTER

EXTRA FEE

1201	A/HA/AA The \$2,500 Grier School Hunter Derby (2'6"/2'9"/3').....	NA.....	\$250
*1520	ABS A/HA/AA Green Working Hunter Derby CH (2'6"/2'9")	NA.....	\$250
	<u>1520 Open to only Sweepstakes Breeding or Original Entries</u>		

New Classes OR Changes For 2025 Are Shaded

* / Sweepstakes Allocated Payout

W / Warm-up Round @ \$30 per class

*Grey highlight indicates changes for 2025



number CLASS

TOTAL FEE per class

The below classes include a warm-up round before your judged round

3302	A/HA/AA Working Hunter ATR 2' CH	W \$30	\$280
266	Arabian Working Hunter CH (3')	W \$30	\$280
269	Arabian Working Hunter AAOTR CH (2'9")	W \$30	\$280
271	Arabian Working Hunter ATR CH (2'6")	W \$30	\$280
278	Arabian Green Working Hunter CH (2'6"/2'9")	W \$30	\$280
711	HA/AA Working Hunter CH (3')	W \$30	\$280
714	HA/AA Working Hunter AAOTR CH (2'9")	W \$30	\$280
716	HA/AA Working Hunter ATR CH (2'6")	W \$30	\$280
724	HA/AA Green Working Hunter CH (2'6"/2'9")	W \$30	\$280

HUNTER SEAT EQUITATION

940	A/HA/AA Hunt Seat Equitation Not To Jump ATR CH	\$250
947	A/HA/AA Hunt Seat Equitation Over Obstacles ATR CH (2'9") Quals waived	\$250

JUMPER

1149	A/HA/AA Power & Speed Jumper CH (0.8M)	\$250
1801	A/HA/AA Open Jumper Stake (1M)	\$250
1803	A/HA/AA Jumper ATR CH (0.8M)	\$250
1805	A/HA/AA Novice Jumper CH (0.7M)	\$250

EVENTING / TRIALS

3200	A/HA/AA Beginner Novice Combined Training CH	\$250
	<u>Dressage Section A</u> <u>Jumper Section B (0.8M)</u>	

ARABIAN HORSE ASSOCIATION MATURITY PROGRAM

OPEN TO HORSES 5 & 6 YRS. OLD

****Two part entry:**

- **Must be nominated and nominations paid up prior to the show.**
- **Must enter the class on the official entry form & pay the class entry fee.**

The AHA Futurity Commission has put the following Maturity classes on a 2-year probation.

1743	Arabian Sport Horse Under Saddle AOTR Maturity (5 & 6 Yr. Olds)	\$250
D 1744	HA/AA Sport Horse Under Saddle AOTR Maturity (5 & 6 Yr. Olds)	\$250

EXHIBITION

2500	A/HA/AA \$5,000 Musical Freestyle Exhibition (English or Western)	\$125
482	A/HA/AA Low Working Hunter Open (2'6") Exhibition	\$125
3222	A/HA/AA Optimum Time Jumper (0.70M) Exhibition	\$125

New Classes OR Changes For 2025 Are Shaded**D** / DNA Required***** / Sweepstakes Allocated Payout



2025 SPORT HORSE NATIONALS ARABIAN & HALF-ARABIAN CHAMPIONSHIP HORSE SHOW

TENTATIVE SCHEDULE
September 8 - 13, 2025 Wilmington, OH
WORLD EQUESTRIAN CENTER

This schedule is based on entry projections for each class, and the number of sections required.
The Show Commission will review class entry numbers and sections after the entry deadline and will revise accordingly if deemed necessary. Any change in the number of entries may effect corresponding number of sections for that class.
CH = Championship HAAA = Half-Arabian/Anglo-Arabian A/HAAA = Arabian A/B/C = Elimination Section SF/F = Semi Final/Final Section

Please check on the App or in the show office for any changes.

When entering, please be aware of entering classes which might run in different rings at the same time. Every effort will be made to solve these conflicts however rings will not be held for extensive periods to solve conflicts. Entry fees will be forfeited in case of time conflicts caused by two rings running simultaneously that can't be resolved. Classes where sections are scheduled but cancelled, the SFF MAY run where the sections were scheduled. Classes scheduled with only a SFF that is divided into sections, will have the sections run in place of the SFF and the SFF will be later in the schedule.

LUNCH BREAKS IN EACH RING WILL BE TBA AND MAY NOT BE THE SAME FOR ALL RINGS

Hunter Type in Hand (H1)

Danielle Ackley (H1), Phillip Long (H2)

Hunter Type Under Saddle (HT) MOS

Danielle Ackley (H3), Phillip Long (H4) Rhodes (H5) or Sparks (H8)

H/J Judges will rotate for the SH US Hunter Type

Dressage Type in Hand (D1)

Gwen Ka'awaloa (D1), Peter Hansen (D2)

Dressage Type Under Saddle (DT) (MOS)

Gwen Ka'awaloa (D3), Peter Hansen (D4), Wayne Quarles (D5)

Hacking will be allowed in the hunter ring in the mornings prior to the jump crew setting the course and the drag. No jumping is allowed. The rings will be open in the evening for schooling for one hour every day, weather and time permitting, and the schooling times for each day will be announced.

Judges, Judging Panels and/or Judging order is subject to change

Eventing (E) = Wayne Quarles

Team 1 (T1) = Ackley, Ka'awaloa

Team 2 (T2) = Long, Hansen

Team 3 (T3) = All 4 In Hand Judges

Carriage Driving (C) = Kall Palmer-Miller

Dressage/Western Dressage

Michell Combs (D/r, WD/R)

Lisa El-Ramey (D/S)

Dolly Hannon (D,YH,F/S - WD/R)

Michael Osinski (D,YH,F/S)

Debbie Riehl-Rodriguez (D,YH,F/S - WD/R)

Dorie Viatten-Schmitz (D,YH,F/S)

Western Dressage Hack/Suitability - Ka'awaloa, Quarles

Dressage Classes may not run in the order or on day listed*

Sunday September 7, 2025

9:00 am - 5:00 pm EXHIBITORS WELCOME PARTY 6 PM
Hunter Jumper All Day Schooling

Monday September 8, 2025

SPORT HORSE RING - SANCTUARY				HUNTER JUMPING RING 9:00 AM				DRESSAGE COURTS 8:00 am			
#	BREAKS TBA	SEC	Team	#	BREAKS TBA	Sec	Team	#	Court	Sec	Team
2881	HAAA SH Mare in Hand Dressage Type 3 & over CH	SF/F	D1	361	Arabian Hunter Hack CH (26")	SF/F	H/J	Court 1 (R & L)	RE		
1723	SHN Arabian Sport Horse in Hand 3 yr old Jackpot - Stallions	SF/F	T2	365	Arabian Hunter Hack ATR CH (23")	SF/F	H/J	1401	Arabian Dressage Training Level CH	SF/F	
2801	Arabian SH Gelding in Hand Dressage Type 3 & over CH	SF/F	D1	368	Arabian Hunter Hack Junior Horse CH (23")	SF/F	H/J	Court 2 (R & L)	VO		
				767	HAAA Hunter Hack CH (26")	SF/F	H/J	1416	Arabian Dressage Third Level ATR CH	SF/F	
2821	HAAA SH Mare in Hand Hunter Type 3 & over CH	SF/F	H1	771	HAAA Hunter Hack ATR CH (23")	SF/F	H/J	883	A/HAAA Dressage Prix St. George CH	SF/F	
1992	SHN HAAA Sport Horse in Hand 3 yr old Jackpot - Geldings/Stallions	SF/F	T1	765	HAAA Hunter Hack Junior Horse CH (23")	SF/F	H/J	1412	HAAA Dressage Second Level AAOTR CH	SF/F	
2741	Arabian SH Gelding in Hand Hunter Type 3 & over CH	SF/F	H1					889	A/HAAA Dressage Grand Prix CH	SF/F	
				3301	A/HAAA Working Hunter OF ATR 2	A	H/J	Court 3 (Roberts)			
1553	HAAA Sport Horse Under Saddle AOTR Hunter Type CH	A	H8	3301	A/HAAA Working Hunter OF ATR 2	B	H/J	3200	A/HAAA Beginner Novice Combined Training CH	A	E
1553	HAAA Sport Horse Under Saddle AOTR Hunter Type CH	B	H8	3301	A/HAAA Working Hunter ATR 2 US/CH	C /FNL	H/J	Dressage section A			
2680	Arabian Sport Horse Under Saddle Hunter Type CH	A	H3					1501	HAAA Dressage Training Level CH	SF/F	CH
2680	Arabian Sport Horse Under Saddle Hunter Type CH	B	H3								
1051	HAAA Sport Horse Snow Hack	SF/F	D4								
1552	Arabian Sport Horse Under Saddle AOTR Dressage Type CH	A	D4								
1552	Arabian Sport Horse Under Saddle AOTR Dressage Type CH	B	D4								
2692	HAAA Sport Horse Under Saddle Dressage Type CH	A	D5								
2692	HAAA Sport Horse Under Saddle Dressage Type CH	B	D5								
352	Arabian Sport Horse Show Hack ATR CH	SF/F	D4								



DRESSAGE AWARDS WILL BE APPROX 5 PM EACH DAY AND PRESENTED IN THE ORDER THEY CLOSE OUT.

The Sanctuary will be closed for 1 hour after classes for driving practice ONLY



2025 SPORT HORSE NATIONALS

TENTATIVE CLASS SCHEDULE



Tuesday September 9, 2025									
SPORT HORSE RING - SANCTUARY					HUNTER JUMPER RING 9:00 AM			DRESSAGE COURTS 8:00 am	
#	BREAKS TBA	Sec	Team	#	BREAKS TBA	Sec	Team	#	Team
Triangle 1 8:00am				Hunter Warm Up Will Precede Your Judged Round				Court 1 (R & L)	
2921	HA/AA Sport Horse Gelding In Hand Dressage Type 3 & over CH	SFF	D2					1407	HA/AA Dressage First Level AAOTR CH
1991	SHN HA/AA Sport Horse In Hand 3 yr old Jackpot - Mare	SFF	T1					1405	Arabian Dressage First Level AAOTR CH
2769	Arabian Sport Horse Mare In Hand Dressage Type ATH 3 & Over CH	SFF	D2	278	Arabian Green Working Hunter OF (26'x29')	A	H/J		
1696	Sport Horse Showmanship ATR CH	SFF	T1	278	Arabian Green Working Hunter OF (26'x29')	B	H/J		
				278	Arabian Green Working Hunter US/CH	C /FNL	H/J		
Triangle 2 8:00 am				724	HA/AA Green Working Hunter OF (26'x29')	A	H/J		
2861	HA/AA Sport Horse Gelding In Hand Hunter Type 3 & over CH	SFF	H2	724	HA/AA Green Working Hunter OF (26'x29')	B	H/J		
1722	SHN Arabian Sport Horse In Hand 3 yr old Jackpot - Geldings	SFF	T1	724	HA/AA Green Working Hunter OF (26'x29')	C /FNL	H/J		
2709	Arabian Sport Horse Mare In Hand Hunter Type ATH 3 & Over CH	SFF	H2	724	HA/AA Green Working Hunter US/CH				
485	HA/AA Sport Horse Stallion In-Hand CH	SFF	T2	266	Arabian Working Hunter OF (3)	A	H/J		
				266	Arabian Working Hunter OF (3)	B	H/J		
				266	Arabian Working Hunter US/CH	C /FNL	H/J		
1232	AH/AA Carriage Pleasure Driving - Turnout CH	SFF	C	711	HA/AA Working Hunter OF (3)	A	H/J		
1248	AH/AA Carriage Pleasure Driving - Drive & Ride CH	SFF	C	711	HA/AA Working Hunter OF (3)	B	H/J		
				711	HA/AA Working Hunter US/CH	C /FNL	H/J		
FIRST TIME EXHIBITOR PRESENTATIONS									
EVENING - Not Before 5:30									
348	Arabian Sport Horse Show Hack	SFF	D5						
2690	HA/AA Sport Horse Under Saddle Hunter Type ATR CH	A	H7						
2690	HA/AA Sport Horse Under Saddle Hunter Type ATR CH	B	H7						
2518	AH/AA Western Dressage Suitability CH	SFF	WD						
2686	Arabian Sport Horse Under Saddle Dressage Type ATR CH	A	D5						
2686	Arabian Sport Horse Under Saddle Dressage Type ATR CH	B	D5						
1767	HA/AA Sport Horse Under Saddle Junior Horse Hunter Type CH	SFF	H1						
1055	HA/AA Sport Horse Show Hack ATR CH	SFF	D4						
1743	Arabian Sport Horse Under Saddle AOTR Maturity 5 & 6 yr olds	SFF	T2						
2418	AH/AA Western Dressage Hack CH	SFF	WD						
2688	HA/AA Sport Horse Under Saddle Hunter Type CH	A	H6						
2688	HA/AA Sport Horse Under Saddle Hunter Type CH	B	H6						

DRESSAGE AWARDS WILL BE APROX 5 PM EACH DAY AND PRESENTED IN THE ORDER THEY CLOSE OUT.



DRESSAGE AWARDS WILL BE APPROX 5 PM EACH DAY
AND PRESENTED IN THE ORDER THEY CLOSE OUT.





EVENT RULES & INFORMATION

All Entry Forms Available @ www.arabianhorses.org/nationalevents

Wednesday September 10, 2025

SPORT HORSE RING - SANCTUARY				HUNTER JUMPER RING 9:00 AM				DRESSAGE COURTS 8:00 am			
BREAKS TBA				BREAKS TBA							
Triangle 1: 8:00 am	Team	#	Team	Sec	Team	#	Team	Sec	Team	Sec	Team
2761 Arabian Sport Horse Mare in Hand Dressage Type 3 & Over CH	DT										
1331 HAA/AA 2 Year Old Sport Horse Colt/Geldling In Hand CH	T1										
\$1,500 Available Sweepstakes Prize Money for those eligible											
CH - \$400 RC - \$300 TT - \$100											
599 Arabian 2 Year Old Sport Horse Colt In Hand CH	T1										
\$1,500 Available Sweepstakes Prize Money for those eligible											
CH - \$400 RC - \$300 TT - \$100											
600 Arabian 2 Year Old Sport Horse Geldling In-Hand CH	T1										
\$1,500 Available Sweepstakes Prize Money for those eligible											
CH - \$400 RC - \$300 TT - \$100											
Triangle 2: 8:00 am											
2701 Arabian Sport Horse Mare in Hand Hunter Type 3 & Over CH	H1										
601 Arabian Sport Horse 2 Year Old Filly In Hand CH	T2										
\$1,500 Available Sweepstakes Prize Money for those eligible											
CH - \$400 RC - \$300 TT - \$100											
604 HAA/AA 2 Year Old Sport Horse Filly In Hand CH	T2										
\$1,500 Available Sweepstakes Prize Money for those eligible											
CH - \$400 RC - \$300 TT - \$100											
Evening: Not Before 5:30 PM											
1551 Arabian Sport Horse Under Saddle AOTR Hunter Type CH	H5										
1551 Arabian Sport Horse Under Saddle AOTR Hunter Type CH	H5										
1678 Arabian Sport Horse Under Saddle Junior Horse Dressage Type CH	D3										
1678 Arabian Sport Horse Under Saddle Junior Horse Dressage Type CH	D3										
1744 HAA/AA Sport Horse Under Saddle AOTR Maturity 5 & 6 yr olds	T1										
2684 Arabian Sport Horse Under Saddle Dressage Type CH	D3										
2684 Arabian Sport Horse Under Saddle Dressage Type CH	D3										
1554 HAA/AA Sport Horse Under Saddle AOTR Dressage Type CH	D3										
1554 HAA/AA Sport Horse Under Saddle AOTR Dressage Type CH	D3										

DRESSAGE AWARDS WILL BE APPROX 5 PM EACH DAY AND PRESENTED IN THE ORDER THEY CLOSE OUT.

Jumping Ring Carriage PL Driving 11 AM

1322 A/HAA/AA Carriage PL Driving Timed Obstacle CH SF/F C

Jumping Ring Carriage PL Driving 3 PM

1297 A/HAA/AA Pick Your Own Route SF/F C



ATTENTION COMPETITORS

Each competitor is responsible for supplying management with correct applicable numbers (USDF and USEF) for horse, owner, rider, and trainer, before the day(s) of the competition.

The scores of competitors who fail to supply correct numbers may not be counted towards national awards.



2025 SPORT HORSE NATIONALS

TENTATIVE CLASS SCHEDULE



Thursday September 11, 2025									
SPORT HORSE RING - SANCTUARY					HUNTER JUMPER RING 9:00 AM				
BREAKS TBA			BREAKS TBA						
#	Team	Sec	#	Team	Sec	#	Team	Sec	Team
Triangle 1: 8:00 am									
2889 HA/AA Sport Horse Mare In Hand Dressage Type 3 & Over ATH CH	D2	SF/F	3222 AH/AAA Optimum Time Jumper Exhibition (0.70M)	H/J	SF/F	Court 1 (R & L)			EV
1022 ABS Arabian Sport Horse In Hand Yearling Filly CH	T1	SF/F	1805 AH/AAA Novice Jumper CH (0.7M)	H/J	SF/F	1503 HA/AA Dressage Training Level ATR CH			SF/F
\$10,000 available to Sweepstakes enrolled Breeding Entries			1803 AH/AAA Jumper ATR CH (0.8M)	H/J	SF/F	1409 Arabian Dressage Second Level AAO TR CH			SF/F
CH - \$2,500 RC - \$1,500 TT - \$750			1149 AH/AAA Speed Jumper CH (0.8M)	H/J	SF/F				
1024 ABS HA/AA Sport Horse In Hand Yearling Filly CH	T1	SF/F				Court 2 (R & L)			RO
\$10,000 available to Sweepstakes enrolled Breeding Entries						1420 Arabian Dressage Fourth Level CH			SF/F
CH - \$2,500 RC - \$1,500 TT - \$750						1413 HA/AA Dressage Second Level ATR CH			SF/F
Triangle 2: 8:00 am									
2829 HA/AA Sport Horse Mare In Hand Hunter Type 3 & Over ATH CH	H2	SF/F	1801 AH/AAA \$2,500 Open Jumper Stake (0.1M)	H/J	SF/F	1424 HA/AA Dressage Fourth Level CH			SF/F
1025 ABS HA/AA Sport Horse In Hand Yearling Colt/Gelding CH	T2	SF/F	482 AH/AAA Low Working Hunter Open 26' EXH	H/J	SF/F	887 AH/AAA Dressage Intermediate I CH			SF/F
\$10,000 available to Sweepstakes enrolled Breeding Entries									
CH - \$2,500 RC - \$1,500 TT - \$750									
1023 ABS Arabian Sport Horse In Hand Colt/Gelding Yearling CH	T2	SF/F				Court 3 (Roberts)			HC
\$10,000 available to Sweepstakes enrolled Breeding Entries						2502 AH/AAA Western Dressage Level 2 CH			SF/F
CH - \$2,500 RC - \$1,500 TT - \$750						1574 HA/AA Western Dressage Basic ATR CH			SF/F
EVENING Not Before 5:00 PM									
1088 Sport Horse In-Hand Juvenile Supreme Championship	T3	FNL				2571 AH/AAA Western Dressage Level 4 CH			SF/F
1679 Arabian Sport Horse Under Saddle Junior Hunter Type CH	H6	SF/F				2304 AH/AAA Western Dressage Basic Level Jr Horse			SF/F
2694 HA/AA Sport Horse Under Saddle Dressage Type ATR CH	A	SF/F							
2694 HA/AA Sport Horse Under Saddle Dressage Type ATR CH	B	SF/F							
2682 Arabian Sport Horse Under Saddle Hunter Type ATR CH	A	SF/F							
2682 Arabian Sport Horse Under Saddle Hunter Type ATR CH	B	SF/F							
1553 HA/AA Sport Horse Under Saddle AOTR Hunter Type CH	H8	SF/F							
2686 Arabian Sport Horse Under Saddle Dressage Type ATR CH	D5	SF/F							
1766 HA/AA Sport Horse Under Saddle Junior Horse Dressage Type CH	D5	SF/F							

DRESSAGE AWARDS WILL BE APPROX 5 PM EACH DAY AND PRESENTED IN THE ORDER THEY CLOSE OUT.

JOG PARTY Vendor Village
Time TBA
(Following the Mandatory lot)

ABS Dressage Prospect Mandatory Jog
Bradley Arena (Time TBA)

Double Jeopardy Champ

Jumper Ring Carriage PL Driving 5:00 PM

Jumper Ring Carriage PL Driving 1:30 PM

Jumper Ring Carriage PL Driving 10:00 AM

Jumper Ring Carriage PL Driving Scurry Obstacle CH

Jumper Ring Carriage PL Driving 1:30 PM

Jumper Ring Carriage PL Driving 5:00 PM

Double Jeopardy Champ

ABS Dressage Prospect Mandatory Jog
Bradley Arena (Time TBA)

JOG PARTY Vendor Village
Time TBA
(Following the Mandatory lot)





ABS Dressage Prospect Mandatory Jog
Bradley Arena (Time TBA)

JOG PARTY Vendor Village
Time TBA
(following the Mandatory Jog)



EVENT RULES & INFORMATION

All Entry Forms Available @ www.arabianhorses.org/nationalevents

Friday September 12, 2025

SPORT HORSE RING - SANCTUARY				HUNTER JUMPER RING 9:00 AM				DRESSAGE COURTS 8:00 am			
BREAKS: TBA				BREAKS: TBA							
Triangle 1 8:00 am				There are no Warm-Up rounds for Equitation							
#		Sec	Team	#		Sec	Team	#		Sec	Team
2809	Arabian Sport Horse Gelding In Hand Dressage Type 3 & Over ATH CH	SF/F	D2	947	A/H/A/A Hunter Seat Equ OF ATR CH (29')	SF/F	H/J	1411	Arabian Dressage First Level CH	SF/F	OE
2789	Arabian Sport Horse Stallions In Hand Dressage Type 3 & Over ATH CH	SF/F	D1	Hunter Warm Up Will Precede Your Judged Round				1410	Arabian Dressage Second Level ATR CH	SF/F	
Triangle 2 8:00 am				269	Arabian Working Hunter AAOIR OF (29')	A	H/J	3217	Arabian Western Dressage Level 1 CH	SF/F	CR
2749	Arabian Sport Horse Gelding In Hand Hunter Type 3 & Over ATH CH	SF/F	H2	269	Arabian Working Hunter AAOIR OF (29')	B	H/J	2552	A/H/A/A Western Dressage Level 3 CH	SF/F	
2729	Arabian Sport Horse Stallion In Hand Hunter Type 3 & Over ATH CH	SF/F	H1	269	Arabian Working Hunter AAOIR US/CH	C (FNL)	H/J	1511	H/A/A/A Dressage First Level CH	SF/F	
Afternoon Not Before 4:00 PM				714	H/A/A/A Working Hunter AAOIR OF (29')	A	H/J	Court 2 (R & L)			
1228	A/H/A/A Carriage Driving Working	SF/F	C	714	H/A/A/A Working Hunter AAOIR OF (29')	B	H/J	Court 3 (Roberts)			
1236	A/H/A/A Carriage Reinsmanship	SF/F	C	714	H/A/A/A Working Hunter AAOIR US/CH	C (FNL)	H/J	** 1504	ABS A/H/A/A Dressage Prospect Incentive	SF/F	HV
EVENING Not Before 5:30				1601	A/H/A/A 14.2 & Under Working Hunter OF (26')	A	H/J	\$15,000 Available Sweepstakes Prize Money for those			
2680	Arabian Sport Horse Under Saddle Hunter Type CH	SF/F	H3	1601	A/H/A/A 14.2 & Under Working Hunter OF (26')	B		CH - \$4,000 RC - \$3,000 TT - \$1,000			
1506	ABS H/A/A Sport Horse 7 & Over Under Saddle AOTR Jackpot CH	SFF	T2	1601	A/H/A/A 14.2 & Under Working Hunter US/CH	C (FNL)		1402	Arabian Dressage Training Level AAOIR CH	SF/F	
Up to \$15,000 Sweepstakes plus Jackpot fee @ \$500 per horse				DRESSAGE AWARDS WILL BE APPROX 5 PM EACH DAY AND PRESENTED IN THE ORDER THEY CLOSE OUT.							
1678	Arabian Sport Horse Under Saddle Junior Horse Dressage Type CH	SF/F	D3	Awards for DPI Best Dresses and Best Turn out Right after Awards for TT for Dressage Prospect							
1551	Arabian Sport Horse Under Saddle AOTR Hunter Type CH	SF/F	H5	Roberts Areana							
2690	H/A/A/A Sport Horse Under Saddle Hunter Type ATR CH	SF/F	H7	2500 A/H/A/A \$5,000 Musical Freestyle Exhibition							
2684	Arabian Sport Horse Under Saddle Dressage Type CH	SF/F	D3								
1554	H/A/A/A Sport Horse Under Saddle AOTR Dressage Type CH	SF/F	D3								

Saturday September 13, 2025

SPORT HORSE RING - SANCTUARY				HUNTER JUMPER RING 9:00 AM				DRESSAGE COURTS 8:00 am			
BREAKS: TBA				BREAKS: TBA							
Triangle 1 8:00 am				There are no Warm-Up rounds for the Hunter Derby or the Equitation.							
#		Sec	Team	#		Sec	Team	#		Sec	Team
2929	H/A/A/A Sport Horse Gelding In Hand Dressage Type 3 & Over ATH CH	SF/F	D1	College Football Day. Wear your favorite team Jersey				1502	H/A/A/A Dressage Training Level AAOIR CH	SF/F	OH
2781	Arabian Sport Horse Stallion In Hand Dressage Type 3 & Over CH	SF/F	D2	940	A/H/A/A Hunter Seat Equ Not To Jump ATR CH	SF/F	H/J	828	A/H/A/A Dressage Fourth Level ATR CH	SF/F	
1721	SHN Arabian Sport Horse In Hand 3 yr old Jackpot - Mare	SF/F	T2	1520	A/H/A/A ABS Green Working Hunter Derby	SF/F	H/J	1419	H/A/A/A Dressage Third Level ATR	SF/F	
Triangle 2 8:00 am				\$15,000 Available Sweepstakes Prize Money for				Court 2 (R & L)			
2869	H/A/A/A Sport Horse Gelding In Hand Hunter Type 3 & Over ATH CH	SF/F	H1	CH - \$4,000 RC - \$3,000 TT - \$1,000				1421	Arabian Dressage Second Level CH	SF/F	VE
2721	Arabian Sport Horse Stallions In Hand Hunter Type 3 & Over CH	SF/F	H2	1201	A/H/A/A The Grier School Hunter Derby CH (2'6"/29'3")	SF/F	H/J	1406	Arabian Dressage First Level ATR CH	SF/F	
EVENING Not Before 5:30				DRESSAGE AWARDS WILL BE APPROX 5 PM EACH DAY AND PRESENTED IN THE ORDER THEY CLOSE OUT.							
1552	Arabian Sport Horse Under Saddle AOTR Dressage Type CH	SF/F	D4								
2694	H/A/A/A Sport Horse Under Saddle Dressage Type ATR CH	SF/F	D4								
2682	Arabian Sport Horse Under Saddle Hunter Type ATR CH	SF/F	H4								
2688	H/A/A/A Sport Horse Under Saddle Hunter Type CH	SF/F	H6								
1505	ABS Arabian Sport Horse 7 & Over Under Saddle AOTR Jackpot CH	SF/F	T1								
Up to \$15,000 Sweepstakes plus Jackpot fee @ \$500 per horse											
2692	H/A/A/A Sport Horse Under Saddle Dressage Type CH	SF/F	D5								
1026	A/H/A/A Sport Horse In Hand 3 & Over Supreme Champion	FNL	T3								
Senior Star Award Presentation while Supreme is being tabulated											
Presentation for the Dave & Molly Stanley Juvenile Sport Horse In Hand Award											

PLEASE REFER TO GENERAL RULES FOR ALL SHOWS

ENTRY INFORMATION

Please refer to the General Rules GR 18

CLOSING DATE > JULY 29

Refer to **Important Dates & Deadlines** (see page 91) for additional dates.

When entering, please be aware of entering classes which might run in different rings at the same time. Every effort will be made to solve these conflicts, however rings will not be held for extensive periods to solve conflicts. Entry fees will be forfeited in case of time conflicts caused by two rings running simultaneously that can't be resolved.

Exhibitors are advised to use a form of expedited, traceable mail service when sending entries in order to ensure entries are received by AHA.

- ➔ METERED MAIL will only be accepted with an official postmark from a post office from the country of origin that indicated the location and date the Postal Service accepted custody of a mail piece and cancels affixed postage.
- ➔ If you email your entries, please contact AHA if you do NOT get a return email acknowledging the receipt of your entry on the same or next business day.
- ➔ AHA will accept faxed/mailed entries with a valid credit card. However, we strongly discourage faxed entries. Photos of an entry form will not be accepted. Photos and Faxed Copies are often illegible.
- ➔ **DO NOT SUBMIT AN ENTRY BY MORE THAN ONE METHOD AS CREDIT CARDS MAY BE CHARGED MULTIPLE TIMES.**

FULL PAYMENT must accompany your entry.

Please do not split any charges for an entry between exhibitors, horses or stables.

Checks and credit cards covering multiple entries need to be accompanied by a detailed description

of how the money is to be applied listing all the horses and total fees on a per horse and a contact phone number.

Mail to: Attn: Sport Horse Nationals
6030 Greenwood Plaza Blvd., Suite 100
Greenwood Village, CO 80111

Fax to: 303-696-4599 (please include cover sheet)

Email to: NationalEvents@ArabianHorses.org

ENTERING FOR HORSES & RIDERS NOT QUALIFIED BY THE CLOSING DATE

Horses and riders that enter by closing date but are not qualified for a class(es) as of the closing date of July 29, but intend to qualify for the class(es) before the start of the National Show they are entering **MUST** enter and pay all the fees. This helps in determining if a class must be split or not and a revised schedule published before the start of the show. **Qualifications for classes can be earned up to the start of the show.**

Qualifications for classes can be earned up to the start of the show.

If you do not qualify for the class, the class fee will be refunded.

ENTRY REFUNDS

Please refer to GR 8.10

SHOW ACCOUNTS

Please refer to GR 18.7

All open accounts must be closed by **5 PM on the last day of the show, or management will close all remaining show accounts and will be assessed a Failure to Close Out fee of \$100.00.**

HORSES NOT ENTERED IN THE SHOW

Please refer to GR 31

Non-Competing horses will be accepted at Sport Horse Nationals If a stall is available and must check with the barn manager on stall availability. There will be a \$750.00 fine per NC horse for not filing an official entry form with the show office.



EVENT RULES & INFORMATION

All Entry Forms Available @ www.arabianhorses.org/nationalevents

UNREGISTERED HORSES

Please refer to GR 45

RIDER/HANDLER EQUITATION HORSE CHANGES

Please refer to GR 8.9

The order of go in all equitation classes is random.

Any changes to the rider, driver, handler or equitation horse originally entered must be submitted to the Show Secretary by:

9 PM > the night prior for Morning classes

11 AM > for Afternoon classes

4 PM > for Evening classes

Changes made after the deadline will result in a late change fee.

Changes can be done on the AHA App, website, or in person at the show office.

Once a class section has run, rider/driver/handler changes for advancing sections are not allowed except for a medical emergency per USEF rules. Please make sure the correct rider is listed for your classes.

SCRATCHES & NO SHOWS

Please refer to GR 8.5

By scratching as early as possible enables the show commission to make a timely decision on cancelling sections. Scratches must be recorded with the Show Secretary to be considered official and be in the show office by:

9 PM > the night prior for Morning classes

11 AM > for Afternoon classes

4 PM > for Evening classes

Scratches made after the deadline will result in a late change fee.

Changes can be done on the AHA App, website, or in person at the show office.

Exhibitors who scratch at the gate MUST still submit an official form to the show office.

Once a class section has run, rider/driver/handler changes for advancing sections are not allowed except for a medical emergency per USEF rules. Please make sure the correct rider is listed for your classes.

CLASS SECTION REQUESTS

Please refer to GR 8.6

Exhibitors with possible ring conflicts should identify section requests on the Official Entry Form. At the show, sections can be requested via **the AHA App, website, or in person at the show office**. All requests MUST be submitted BY NOON the day before when the sections are to be posted. Sections will be posted one day prior to the scheduled class. **If you have multiple classes on the same day, it is strongly advised to look closely at the schedule and request a section that will work best for your situation.**

ARENA SIGNS

Arena signage may be purchased using the form found on the AHA website. Arena signage space is limited and will be sold on a first come, first served basis. AHA will provide the arena signs that will be displayed in the arena of your choice. The signs are 3' x 4'.

Logo for the signs must be emailed to National-Events@ArabianHorses.org to AHA by July 31.

Artwork must be in .jpg or .png format and must be high resolution. AHA is not liable for exact color match. More Information can be found on the Sport Horse Nationals webpage or call AHA at (303) 696-4500.

AWARDS

Please refer to GR 5 for complete information

The awards room will be open for your convenience September 8- 13, from 8 AM until a 1/2 hour after classes end.

All awards not claimed by the close of the show will be forfeited with no exceptions.

Duplicate Awards will be for sale in the Awards Room for Champion, Reserve Champion Trophy and Top Ten Plaques. They can be ordered after the event on



2025 **SPORT** HORSE NATIONALS

the Duplicate Award Order form found on the National Events Homepage or you can email NationalEvents@ArabianHorses.org

PRIZE MONEY

RANDOMLY SELECTED CLASSES

\$2,500.00 prize money will be paid to 10 classes; (3) Dressage classes, (1) Carriage Pleasure Driving, (1) Working Hunter, (1) Jumper, (2) Sport Horse In-Hand and (2) Sport Horse Under Saddle] that are randomly selected each year.

The Champion will receive \$1,000, the Reserve Champion will receive \$500 and the balance of the Top Ten will receive \$125.

The following classes will receive prize money for 2025:

- ➔ **714** HA/AA Working Hunter AAOTR CH
- ➔ **1228** A/HA/AA Carriage Pleasure Driving Working CH
- ➔ **1409** Arabian Dressage Send Level AAOTR CH
- ➔ **1501** HA/AA Dressage Training Level CH
- ➔ **1553** HA/AA Sport Horse Under Saddle AOTR Hunter Type CH
- ➔ **1678** Arabian Sport Horse Under Saddle Junior Horse Dressage Type CH
- ➔ **1801** A/HA/AA Jumper CH
- ➔ **2552** A/AH/AA Western Dressage Level 3 CH
- ➔ **2729** Arabian Sport Horse Stallions In-Hand Hunter Type ATH 3 & Over CH
- ➔ **2921** HA/AA Sport Horse Gelding In-Hand Dressage Type 3 & Over CH

ARABIAN BREEDERS SWEEPSTAKES (ABS) PRIZE MONEY CLASSES

Please refer to GR 3

- ➔ **1022** ABS Arabian Yearling SH Filly In-Hand CH
- ➔ **1023** ABS Arabian Yearling SH Colt/Gelding In-Hand CH
- ➔ **1024** ABS HA/AA Yearling SH Filly In-Hand CH
- ➔ **1025** ABS HA/AA Yearling SH Colt/Gelding In-Hand CH

- ➔ **599** Arabian 2 Year-Old SH Colt In-Hand CH
- ➔ **600** Arabian 2 Year-Old SH Gelding In-Hand CH
- ➔ **601** Arabian 2 Year-Old SH Filly In-Hand CH
- ➔ **1331** HA/AA 2 Year Old SH Colt /Gelding In-Hand CH
- ➔ **1505** ABS Arabian Sport Horse Under Saddle AOTR Jackpot
- ➔ **1506** ABS HA/AA Sport Horse Under Saddle AOTR Jackpot

CAMPER & RECREATIONAL VEHICLE FACILITIES

RV Spaces will be available on a first come first serve basis for the entire show.

Please find the form on our website www.ArabianHorses.org

CLASS INFORMATION & SPECS

ARABIAN BREEDERS SWEEPSTAKES (ABS) CLASSES

Please refer to GR 3

REFER TO SWP 116, SWP 117 AND SWP 118 REGARDING PAYBACK FOR ABS NOMINATED HORSES.

ABS SPORT HORSE YEARLING IN-HAND CLASSES

The Yearling Sweepstakes Classes are restricted to Breeding Entries only. This is the only qualification for these classes for Sport Horse Nationals.

Yearlings are NOT permitted to cross enter into the Open or Amateur to Handle classes. Yearlings must be shown in a plain leather stable halter as described in AR 183

ABS DRESSAGE PROSPECT INCENTIVE

The ABS Dressage Prospect Incentive class is restricted to 4- and 5-year-old horse enrolled as a Breeding or Original Entry.

This class is exempt from the 50% rule. Refer to SWP 116, SWP 117 and SWP 118 regarding payback for ABS nominated horses.

The AHA Dressage Prospect Incentive Test will be used and can be found on the AHA Website.



EVENT RULES & INFORMATION

All Entry Forms Available @ www.arabianhorses.org/nationalevents

Horses will be examined for soundness. A jog will be scheduled the day prior to the Championship class at which time all horses must be presented to the official veterinarian and a member of the dressage judging panel for examination.

Horses will be jogged on packed dirt or tarmac. Horses not presented for the jog or who do not pass the jog will not be eligible to show in the class.

Horses who do not pass the jog will be sent to a designated holding area and will be re-jogged after all the other entries have been jogged. If the horse does not pass again, they can be represented the next morning. The official veterinarian and dressage judge who conducted the first presentation will evaluate the re-jog.

The two-member judging panel will consist of either One (1) USEF 'R' Judge and one (1) USEF 'S' Judge or two (2) USEF 'S' judges, both of whom will have the Young Horse designation.

The panel shall sit together at C. Judges shall give one score and fill out general comments on one Marking Sheet.

Competition Management shall provide a sound system and microphone to allow the judges to give the audience a short summary after each ride.

Horses will be ranked in order of their scores in each test.

Breaking of ties for DPI, the marks for "Submission" and "General Impression" will be combined and divided by two in order to break the tie. If still equal, the "Submission" mark would decide. If a tie still exists, breaking of ties will be at the judging panel's discretion. DR123.3

Whips are not allowed.

ABS GREEN WORKING HUNTER DERBY CHAMPIONSHIP

This class is exempt from the 50% rule. Refer to SWP 116, SWP 117 and SWP 118 regarding payback for ABS nominated horses.

The ABS Green Working Hunter Derby Championship is restricted for Green Working Hunters A/HA/AA which are nominated as a Breeding or Original Entry who are eligible to compete as a green working hunter as outlined in the Arabian Working Hunter rules of USEF.

No qualifications are required and the class is open to any age horse who is eligible to compete as a Green Working Hunter as outlined in the Arabian Working Hunter rules of USEF. The Championship consists of two sections with fence heights offered at both 2'6" and 2'9" and riders choose the height at which their horse(s) compete. First year horses may compete at either 2'6" or 2'9" height but second year horses must compete at 2'9". All horses compete in the first two sections in which they receive numerical scores.

The first round is 10-12 fences with the second round over a shortened course of 6-8 fences. The course will include natural elements and options. The second round will be a Handy Hunter Course.

The 12 horses (or less) from the first round, after all ties are broken, are eligible to return for the second round.

The final score from each round will be added together to obtain an overall total for each horse. The horse with the highest combined score shall be named Champion and the second highest combined score will be named Reserve Champion. The remaining horses are eligible to be named in the Top Ten.

For complete derby rules refer to USEF AR 171.

ABS SPORT HORSE UNDER SADDLE AOTR JACKPOT CLASSES

These classes are restricted to Arabians and Half-Arabian/Anglo-Arabians enrolled as a Breeding or Original Entry and are **7 years** of age and older.

Sweepstakes prize money not awarded will be retained in the Sweepstakes principal fund. The 50% rule does not apply to these classes.

Each competitor will contribute \$500 to a prize money jackpot. The Sweepstakes Program will add \$1,000 per entered and shown horse, up to a maximum of \$15,000 to each of the two purses.

Sweepstakes prize money and the additional Jackpot prize money will be awarded 20% to the Champion, 10% to the Reserve Champion, and 8.75% to each of the remaining Top Ten. Any Jackpot prize money not distributed shall be equally divided among all placings.

A horse that is co-owned by two distinct non family members per USEF AR 110.e.1 – 10 CAN NOT be shown in the AOTR Jackpot classes.



2025 **SPORT HORSE NATIONALS**

NATIONAL PERFORMANCE MATURITY

For complete rules regarding the Performance Maturity Program, please refer to Chapter 20 of the AHA Handbook.

Enrollment in the Maturity Program is required to participate in these classes. These classes are for horses that are 5-6 years old. Enrollment into the program will serve as the qualification for the class, no other qualification is required.

Enrollment into the program *does not* constitute entry in the Sport Horse National Championship Show. Entry into the corresponding class must also be submitted on the Official Show Entry Form.

Sport Horse Performance Maturity nomination form and information can be found on the AHA website www.ArabianHorses.org/export/content.export/aha-forms/270001_SHN.pdf

Payment can be made in full (postmarked by **May 1**) or in payments (due **May 1**, **June 1** and **July 1**). Enrollments made after these dates are subject to late fees. Nominations are allowed (with corresponding late fees) up until the first Post Show Entry Close Date. Prize money for these classes are based on the 50% rule.

DNA FOR HALF-ARABIANS IS REQUIRED FOR THIS CLASS. please REFER TO GR 3.2.

If the DNA is not on file before the class, the horse will be ineligible to be shown.

A/HA/AA \$5,000.00 MUSICAL FREESTYLE EXHIBITION (ENGLISH OR WESTERN)

This Musical Freestyle Exhibition class is not recognized by USEF or USDF. The Musical Freestyle Application (with complete rules) must be submitted with your entry. Open to horses entered in First Level and above at this show. Limited to 15 rides and 1 entry per owner. Rider may only ride 1 horse. If 15 time slots are not filled then it will be open to; 1) Entries on a waiting list and 2) Entries with duplicate riders and/or duplicate owners.

Musical freestyle is an exciting combination of the technical and artistic aspects of a highly trained horse.

The helmet rule is in effect. Whips are permitted.

SHN SPORT HORSE IN-HAND 3 YR OLD JACKPOT

These classes are open to 3-year-old horses. Payment of the Jackpot fee will serve as the qualification for the class, no other qualifications are required. No nominations are required.

Each exhibitor will contribute \$500 to a prize money jackpot. Prize money for each class will be distributed as follows:

- Champion – 25%
- Reserve Champion – 15%
- Remaining Top Ten – 7.5%

These classes are exempt from the 50% rule. Any remaining Top Ten money will be divided equally between all Top Ten Placings.

DNA FOR HALF-ARABIANS IS REQUIRED FOR THIS CLASS. PLEASE REFER TO GR 3.1

If the DNA is not on file before the class, the horse will be ineligible to be shown.

This is a Jackpot Class only. No additional prize money will be issued from AHA prize money programs.

CARRIAGE DRIVING CLASSES

NO QUALIFICATIONS REQUIRED

Carriage driving classes will follow USEF rules for Pleasure Driving (See Articles CP 101-120). Singles and multiples will be allowed in the Carriage Pleasure Driving classes. For multiples you will need to pick one horse to receive all points, awards, and recognition. Wire wheeled, pneumatic tired and combined driving marathon vehicles will not be permitted. No cantering allowed in the obstacle driving class. In the Ride and Drive the rider and driver may be different. A mandatory safety check will occur on all turnouts.

COMBINED TEST BEGINNER NOVICE (EXHIBITION)

NO QUALIFICATIONS REQUIRED

Will run in accordance with USEF EV Chapter. Open to horses four years of age or older (EV Appendix 3.3.1).

A combined test is a competition in which you and your horse complete a dressage test and then jump a show jumping course. It's similar to a three-phase horse trials event, but you don't jump a cross-country course.



EVENT RULES & INFORMATION

All Entry Forms Available @ www.arabianhorses.org/nationalevents

This class will consist of 2 sections (phases), a Dressage Section Judged by one Eventing or Dressage Judge and a Jumping Section judged by one Eventing or Hunter/Jumper Judge.

The Dressage section will run first then the Jumping section.

Fence heights that will be 0.80M (2'7") please refer to USEF EV Appendix 2 under Beginner Novice.

The dressage test will be Beginner Novice Test B. www.beginner-novice-eventing-test-b. This test will also be on the AHA web site.

COMBINED TEST SCORING

For scoring, penalties and eliminations refer to:

- ▶ Dressage section is EV118-EV120 and EV143
- ▶ Jumping section is EV126-EV128

FINAL PLACING

Competitors accumulate penalty points in each section, and at the end of the event, the pair with the lowest score takes home top honors.

DRESSAGE CLASSES

No readers or whips will be allowed.

Exception: Western Dressage classes.

For Reader Exceptions see DR306.7 and Handicapped & Electronic Communication Devices in the General Rules.

Horses may enter no more than two consecutive levels, Freestyle levels included at any one competition. Please see USEF DR 119.2 chart for the levels.

Current USEF/USDF Tests will be used as follows:

- ▶ Training Level –s Test 3
- ▶ 1st Level – Test 3
- ▶ 2nd Level – Test 3
- ▶ 3rd Level – Test 3
- ▶ 4th Level – Test 3
- ▶ Prix St. Georges – Prix St. Georges
- ▶ Intermediate I – Intermediate I
- ▶ **Intermediate A & B (Not Offered at SHN)**
- ▶ Intermediate II – Intermediate II

- ▶ Grand Prix – Grand Prix
- ▶ AHA's Dressage Prospect Incentive Test 2019
- ▶ Western Dressage Basic Level – Test 4
- ▶ Western Dressage Level One – Test 4
- ▶ Western Dressage Level Two – Test 4
- ▶ Western Dressage Level Three – Test 4

DRESSAGE HELMET RULE

When cross entry by rider or horse/rider combination is permitted between Dressage and other Arabian classes at a competition, DR120 and DR121 apply only to the designated Dressage warm up and competition areas, or when an exhibitor is actually warming up for Dressage classes.

Helmet rule is also in effect for musical freestyle dressage riders.

WESTERN DRESSAGE CLASSES (WDAA APPROVED 24-103)

To be eligible to participate and/or compete as an exhibitor, owner, lessee, agent, coach, or trainer in any Western Dressage class or at any Western Dressage Federation Licensed Competition, persons must be active members of WDAA or pay a non-member fee equal to the price of an annual membership for each competition. Please refer to the **General Rules GR 28.2**.

- ▶ **WD SUITABILITY** Will use the 2 Judge Total Points Judging System

Qualifications waived for 2025 & 2026

To be eligible for a Western Dressage Suitability class, a horse must not have shown in a Western Dressage competition/Test at Level 1 or above and/or shown in a Western Dressage Hack class.

- ▶ **WD HACK** Will use the 2 Judge Total Points Judging System

Qualifications waived for 2025 & 2026

Once a horse has been entered and shown in a Western Dressage Hack class, that horse may not subsequently be shown in a Western Dressage Suitability class.



2025 **SPORT** HORSE NATIONALS

WORKING HUNTER CLASSES

NO QUALIFICATIONS REQUIRED

All Fence Heights are listed in the class list for each class.

Working Hunter Championship classes will follow the procedures outlined in the AHA Handbook REQ 213–NATIONAL.

Working Hunter Championships have two jumping classes (A, B) followed by an under saddle class (C) that is the Final. Riders may not be different from class to class (A, B and C). **Exception:** In the Working Hunter Championship classes, if an exhibitor is showing more than one horse, they may appoint another **eligible** rider to ride their other entries in the under saddle class per USEF AR 169.3. **This new designated rider(s) must report to the Show Office for signature(s) and to show proof of membership before the session that the Under Saddle class is held REQ 117.2.**

All horses can compete in both jumping rounds; however this is not a requirement.

A disqualification or elimination from any of the Over Fence's classes or the Under Saddle class does not disqualify the horse from a Championship award.

Riders may be permitted to ride back-to-back rounds at their discretion.

HUNTER HACK CLASSES

The fences at National ATR and AAOTR classes will be set at 2'3" and Open Classes at 2'6". Hunter Hack Championship classes will follow the procedures outlined in the AHA Handbook COMP 810.

HUNTER HACK JUNIOR HORSE

Hunter Hack Championship classes will follow the procedures outlined in the AHA Handbook (REQ 210). Fence heights 2'3".

GREEN WORKING HUNTER CLASSES

Qualifications are not required for Green Working Hunter Championships. However, horses must still be eligible to show in the Green Working Hunter as defined by USEF AR 166.1.b1.b

Refer to AR 170 for breaking ties.

WORKING HUNTER 14.2 & UNDER

This championship is open to any 14.2 and under Working Hunter. Measurement cards must be sent with your entry. Championship will run as defined by USEF in Article AR 169 - 170

\$2,500 GRIER SCHOOL HUNTER DERBY **(2'6"/2'9"/3')**

Grier School Hunter Derby Championships consist of two over-fence classes.

The first round is 10-12 fences with the second round over a shortened course of 6-8 fences. The course will include natural elements and options. The second round will be a Handy Hunter Course.

The 12 horses (or less) from the first round, after all ties are broken, are eligible to return for the second round.

The Championship consists of three sections with fence heights offered at 2'6", 2'9" and 3' and riders choose the height at which their horse(s) compete. First year horses may compete at either 2'6" or 2'9" height but second year horses must compete at 2'9". All horses compete in the first two sections in which they receive numerical scores.

The final score from each round will be added together to obtain an overall total for each horse. The horse with the highest combined score shall be named Champion and the second highest combined score will be named Reserve Champion. The remaining horses are eligible to be named in the Top Ten.

LOW WORKING HUNTER

Low Working Hunter EXHIBITION is an open division. Classes to be run under the guidelines of AR-14 WORKING HUNTER. It will consist of two over-fence classes and an under-saddle class. The fence height is 2'6".

HUNTER SEAT EQUITATION

Refer to USEF AR-28 & USEF EQ. 2

1. NOT TO JUMP (AR 247.3)

Will have a rail work portion and also each competitor will be asked to perform two or more tests. as outlined in the AHA Handbook REQ 209.8.

Judges must work competitors in groups of twenty (20) or less. Exhibitors will be excused



EVENT RULES & INFORMATION

All Entry Forms Available @ www.arabianhorses.org/nationalevents

from the ring following rail work and will perform their tests individually.

2. OVER OBSTACLES (AR246.8 & 9 & AR247)

Qualifications waived for 2025 & 2026

Refer to USEF EQ108.1 & AR 288.1. Course will be posted 24 hours prior to class.

Fence heights are 2'9". This class will follow the procedures outlined in the USEF EQ-2 and USEF AR 247.2.a.2. All competitors will compete in one round over the Hunt Seat Equitation course.

There is no rail work. The top four competitors from each judge's card will remain in the ring and will be required to perform two or more tests from USEF EQ 113, Test 1-17, as designated by the call judge. In determining the Champion and Reserve Champion in the AHA Hunter Seat Equitation Final, the final test may only be completed by the top four riders.

JUMPER CLASSES

Jumper Attire: USEF JP111.9b

Tables: Refer to USEF JP146-JP149

➔ 3222 A/HA/AA Optimum Time Jumper Exhibition (0.70M)

JP149.1 Table IV, Sec 1 – (0.70M)
(Optimum Time First Round)

➔ 1805 A/HA/AA Novice Jumper CH (0.80M)

JP149.1 Table IV, Sec 1 – 0.80M
(Optimum Time First Round)

➔ 1149 A/HA/AA Power and Speed CH (0.90M)

JP146.3d Table II, Sec 2(c) – 0.90M
(Two Phase One Round)

➔ 1803 A/HA/AA Jumper ATR CH (0.80M)

JP146.3b Table II, Sec 2(b) – 0.80M
(Time First Jump-Off, stay in the ring)

➔ 1801 A/HA/AA \$2,500 Jumper Classic CH (1.0M)

JP146.3b Table II, Sec 2(a) – 1.0M
(Time First Jump-Off, leave the ring)

SPORT HORSE CLASSES IN-HAND & UNDER SADDLE

Sport Horse In-Hand classes will be judged using the AHA Sport Horse Score Sheets as specified in the

USEF Rule Book. All Sport Horse In-Hand classes will utilize the "Triangle" method of presenting their horses to the judges. Will utilize open cards, once the number of horses in each of the Sport Horse In-Hand class has been determined, there will be a time frame allocated with time frames for each class. **If you do not show up within the time allotted, you missed your class.** Management will work with exhibitors within the time frame for each class as much as possible.

In keeping with the spirit and tradition of the Sport Horse, the show commission would like to remind exhibitors of the following rules and assure their enforcement.

USEF Rule AR 115.2 Lists causes for mandatory elimination from the ring, including, but not limited to, removal of eyelashes, changing the natural color of the mane and/or tail, and the use of anything other than clear or transparent products on the hooves while being shown in Breeding and/or In-Hand classes.

USEF AR 115.3 An entry must be penalized for: excessive amounts of oil, grease or other similar substances, excessive use of the whip which might disturb other entries, and balding of the area around the eyes or proximal to the muzzle and nostrils.

USEF Rule AR 181 Describes the conduct of sport horse in-hand classes. The commission would remind exhibitors the triangle will be trotted a second time only at the direction of the judge and that the horse is to be shown in an "open position" for conformation judging, otherwise the entry may be eliminated from judging consideration.

USEF Rule AR-183.1 & 2 Describes Attire and Appointments of sport horse in-hand classes and for the Distinguished Handler Award.

Conservative casual attire is recommended for the handler.

USEF Rule AR 185 Describes Attire and Appointments for sport horse under saddle.

Competitors with non-conforming appointments will be eliminated from judging consideration.

Appointments (tack & attire) must adhere to one discipline (dressage or hunter) and are not to be mixed. In classes not split by type, each exhibitor must ensure their appointments (tack & attire) adhere to one



2025 **SPORT** HORSE NATIONALS

discipline only (dressage or hunter). In classes split by dressage type and hunter type, each exhibitor must ensure the appointments (tack & attire) are legal for the type shown. Refer DR120-121, and HU105-107.

Whips are allowed in Sport Horse Under Saddle Dressage Type per USEF AR 107.17. Arabian Breed shows are exempt from rules in DR that are specific to Dressage National Championships where whips are prohibited

SPORT HORSE IN-HAND SHOWMANSHIP

Qualifications waived for 2025 & 2026

Refer to AR 190

Open to horses 3 and over. To be judged on presentation of the horse, neatness and appearance of handler, overall condition of the horse, handling techniques, appropriate tack and equipment, and ability to show the horse to the best advantage. The AHA Individual Sport Horse Showmanship Score Sheet shall be used.

SPORT HORSE TWO YEAR OLD IN-HAND CLASSES

Two-Year-Old horses are NOT permitted to cross enter into the Open or Amateur to Handle classes. AHA Handbook QUAL 104.1.d). Two-Year-Old horses may be shown in a bridle, or a plain leather stable halter as described in USEF AR 183.

SPORT HORSE IN-HAND SUPREME CHAMPION

Champions from each of the Sport Horse In-Hand 3 & Over classes from both the Arabian and Half-Arabian/Anglo-Arabian classes will be allowed to show in this class. Only a Supreme Champion will be placed.

SPORT HORSE IN-HAND JUVENILE SUPREME CHAMPION

Champions from each of the Sport Horse Yearling and 2-year-Old In-Hand classes in both the Arabian and Half-Arabian/Anglo-Arabian classes will be allowed to show in this class. Only a Supreme Champion will be placed.

SUPREME CLASS PROCEDURE & SCORING

The AHA Supreme Score Card will be utilized. [www.Supreme Champion Pattern & Score Card.pdf](http://www.SupremeChampionPattern&ScoreCard.pdf)

Horses will enter the ring one at a time at the walk-in back number order.

Judging begins when the horse enters the ring. The horse shall enter at a walk to the first marker then pick up the trot to the second marker. Upon reaching the third marker the horse will walk to the judges to be presented for judging conformation. In order to satisfy a proper presentation to the judge, horses should be shown in an “open position,” with horse’s head and neck in a natural and comfortable carriage. Following the evaluation by the judges, horses shall walk away from the judges, and then strike a trot until they resume their position in the lineup. The scorecards will be completed by the judges, turned in and the next horse will enter the ring for evaluation.

The placings will be turned into points using the points table under scoring.

COMPETITION ARENAS

The indoor arenas will be available for schooling beginning **Saturday, September 6.**

Lunging or long lining is **NOT** allowed in the indoor arenas.

Riding, schooling or lunging is allowed in the outdoor Schooling rings and Outdoor Ring (see map) prior to Saturday, September 6 and during the show.

The climate-controlled indoor arenas at the World Equestrian Center connect to stable areas by covered walkways, so once you arrive, you’ll never have to go outside. The entire facility is kept at a comfortable 68 degrees throughout. The state-of-the-art HVAC systems keep fresh air flowing. Industrial fans keep the air circulating in each arena.

The following table specifies the dimensions and footing of the competition and warm-up arenas:

- ➡ **R & L Arena** 120 X 615,
Custom blended GGT Footing, climate controlled
- ➡ **The Sanctuary** 210 X 350,
Custom blended GGT Footing, climate controlled
- ➡ **Roberts Arena** 108 x 260,
Premium footing, climate controlled
- ➡ **Roberts Arena schooling Arena** 60 X 150,
Premium footing
- ➡ **Bradley Arena schooling for the Sanctuary**
108 x 208, Custom blended GGT Footing



EVENT RULES & INFORMATION

All Entry Forms Available @ www.arabianhorses.org/nationalevents

WEC Outdoor Horse Show complex:

Jumper Ring.....300' x 180'
 Hunter 1.....280' x 150'
 Hunter 2.....285' x 150'
 Schooling 1.....220' x 180'
 Schooling 2280' x 135'
 Lunging Ring.....320' x 220'

The management may move classes to other arenas if weather or class schedule issues necessitate such a move.

DOGS

Please refer to GR 14

MOTORIZED VEHICLE/GOLF CARTS

All Golf Cart rentals will go through the facility of WEC.

Please refer to GR 30 and USEF Rule GR1301.7 regarding the motorized vehicles, including golf carts, motorcycles, scooters or other farm utility vehicles by minors.

QUALIFICATIONS

Please refer to GR 37

You are qualified from the earliest date you earn the participation required. There is no such thing as re-qualifying.

Please refer to the AHA Handbook or for the web site the following link, www.ArabianHorses.org/competition/resources/qualifications/

Horses must still be eligible to show in the Green Working Hunter as defined by USEF AR162 b.1a.

SCHEDULE & RING CONFLICTS & GATE HOLDS

Please refer to GR 9

If an exhibitor has a conflict between scheduled classes or rings, they can request a gate hold at the show office.

All requests must be submitted to the show office **at least 12 hours prior to the class** or a **minimum of 2 sessions** prior to the session with the conflict.

The request will be reviewed by a commissioner.

The exhibitor requesting the hold must come back to the show office to check if the request was granted or not.

Requests not submitted 12 hours or at least 2 sessions prior MAY not be considered.

Please refer to GR 38

SCORING SYSTEMS

All Sport Horse In-Hand will be scored using the **Two-Judge Total Points System (COMP 502).**

Exception: The Sport Horse In-Hand Supreme will be judged with all 4 Sport Horse In-Hand Judges using the Total Points System.

Western Dressage Hack and Suitability will be scored using the Two-Judge Total Points System.

Carriage Driving will be judged by 1 judge.

The Combined Test will utilize 1 Eventing Judge or 1 Dressage and 1 Jumper Judge.

Dressage will be judged by 2 Judges and scored according to the USEF Rulebook and the AHA Handbook (REQ 208).

ALL Sport Horse Under Saddle classes **divided by type** will be judged using the 3 judges MOS scoring system (COMP 506).

The Two-Judge Total Point system will be used for Sport Horse Under Saddle **not divided** by type, Working Hunter, Hunter Hack, Hunt Seat Equitation and Jumper classes. Placings will be turned into points using the table below.

Points Table			
Place	Points	Place	Points
1	20	6	8
2	16	7	6
3	14	8	5
4	12	9	4
5	10	10	3

No points are awarded to any reserve or 11th place horse.

STABLING/ARRIVAL INFORMATION & FEED & BEDDING

Please refer to GR 43.4

FEED & BEDDING

Exhibitors are permitted to bring in outside feed and bedding for personal use, **HOWEVER, third party deliveries or sales are strictly prohibited.**

Shavings may be ordered with your online entry or on your entry form and **must be received by Tuesday, August 12 to guarantee delivery to your stall upon arrival.**

After August 12, Shavings and Feed may be orders through the AHA APP, however after August 19 there is no guaranteed delivery to your stall upon arrival.

No additional shavings or feed orders will be accepted after **Thursday, September 11, 5 PM.**

STABLING

- ➔ **NO ARRIVAL** is permitted prior to Thursday, September 4, NOON.
- ➔ Stalls must be vacated by Sunday, September 14, by 10 AM.
- ➔ **Past 10 AM SHARP, you will be billed the facility late departure fee of \$50 per hour per stall.**
***NO EXCEPTIONS**

Hot plates, grills either electric, gas or charcoal are not allowed in any of the stalls or barn areas.

Exhibitors will be financially responsible for any alteration/damage per stall (horse or tack).

Stalls are permanent and/or temporary with doors.

All entered horses will be automatically charged for 1 horse stall even if it will be occupying a vacated stall for a vet out or scratched horse, with the exception of legal substitutions per GR 8.7.

A stall reconciliation form will be required from the barn manager for any stall refunds.

TACK STALLS

Refer to GR 43

PLEASE DO NOT LIST ADDITIONAL TACK STALLS ON JUST THE STALL REQUEST FORM OR THEY MAY GET MISSED. PLEASE Fill out an entry form with the Owner/trainer information filled out. Leave the horse information blank.

Tack stalls may be used for the following purposes: sitting areas, dressing rooms, tack rooms, ready rooms, feed rooms, sleep rooms for staff, and equipment storage rooms.

Tack stalls will be assigned subject to their availability.

Exhibitors will be allowed to order as many tack stalls as they believe they will need, however, management reserves the right to limit the number of tack stalls due to availability.

GROUP STABLING – STALL RESERVATION FORM SUBMIT ONLY 1 FORM PER GROUP

AHA must receive a Stable Request for exhibitors wishing to be a part of a group (including online entries) filled out completely listing every owner and horse; otherwise, your stalling is NOT guaranteed.

This form must be sent BEFORE August 12, at Midnight (MT) In-House/Electronically Dated to guarantee the request.

PATRON/ELITE STABLING

Please refer to GR 32 & GR 43

Preferred stalling will be available only to those who are participating as Paton or Elite Sponsors for 2024. Platinum Patronship stalling will be assigned first, followed by Gold Patrons and then Elite Sponsors. All others will be stalled following the stabling of Patrons and Sponsors. These stalling assignments will be based first on category of Patronship/Sponsorship and then by overall seniority within the show.

If a patron purchases a paddock, WEC rules only allow 1 horse in the paddock at the same time and must be monitored by a human at all times.

Stalling seniority from the past sponsorship program will carry over.

Deadline to enroll as a Paton or Elite Sponsor to receive stalling preference is July 31.

EQUINE HEALTH & VACCINATION REQUIREMENTS

Please refer to GR 21

Any updates of the following requirements will be posted on the AHA web site.

BRING ALL HEALTH & VACCINATION PAPERS WITH YOU. Do not send them to AHA or mail them with your entries.



EVENT RULES & INFORMATION

All Entry Forms Available @ www.arabianhorses.org/nationalevents

All horses entering the World Equestrian Center grounds must have:

- ➔ Proof of a current negative Coggins test (within 12 months)
- ➔ A 30-day certificate of veterinary inspection, required for all horses arriving from outside the state of Ohio
- ➔ Proof of mandatory vaccinations, required per US Equestrian rules

Horses who fail to arrive with appropriate equestrian forms and paperwork cannot unload on to show grounds.

WORKING HUNTER/HUNTER HACK JUMPER WARM UPS & SCHOOLING

Lunging or long lining is **NOT** allowed in the indoor arenas.

The indoor arenas will be available for schooling beginning Saturday, September 6.

Riding, schooling or lunging is allowed in the outdoor Schooling rings and Outdoor Ring (see map) prior to Saturday, September 6 and during the show.

ALL DAY OVER FENCE SCHOOLING

All Day schooling will be on the Sunday before the start of the show. The fee will be \$50 per horse and may be purchased on the Official Entry Form or from the show office. Multiple rounds will be allowed as time permits. Show management has the right to limit the number of rounds per horse.

No horses will be allowed to participate that are not entered in Working Hunter, Hunter Hack, Jumper or Hunt Seat Equitation Over Obstacles or Hunter Derby classes. Both trainers and exhibitors will be allowed to ride the horse during the schooling rounds. Back numbers must be worn during schooling rounds. There will be no predetermined order of go.

WORKING HUNTER/HUNTER HACK WARM UPS

One Warm up round is included for Working Hunter classes. It will precede the judged round.

If an exhibitor declines to use the warm-up, they may fill out a form from the Paddock/Gate person to take

to the show office and a \$30.00 credit will be applied to their account after the show in the Denver Office.

Hunter Hack horses and riders will have the opportunity before the start of the class to school and warm-up over the two fences, in the direction they are to be jumped.

There is no charge for this warm-up. Warm-up will be done in groups of five (5) or less, prior to the start of each Hunter Hack class.

There will be NO warm-up rounds for the Hunter Derby or Hunt Seat Equitation Over Obstacles ATR CH.

WORLD EQUESTRIAN CENTER & FIRE MARSHALL & RULES

Please refer to GR 23

- ➔ **WEC Paddock Rules – only 1 horse in the paddock at the same time and must be monitored by a human at all times.**
- ➔ Show Management and exhibitors of any animal brought to the Facility must observe all State of Ohio animal health regulations.
- ➔ All dogs must be restrained on a leash at all times. Pet owners will be responsible for clean-up of droppings.
- ➔ All horses must be washed in the designated wash areas only. No washing may be done in the stalls or alleyways.
- ➔ Fireworks and firearms are prohibited from the grounds.
- ➔ Stalls may be used for tack rooms, feed rooms, sleep rooms for staff, equipment storage rooms.
- ➔ **Hot plates, grills either electric, gas or charcoal are not allowed in any of the stalls or barn areas.**

VIOLATIONS

The AHA National Show Commissions have the authority to penalize participants for infractions of the AHA Rules and/or violation of any show facility rules. At the Commission's direction, such penalties can include (but are not limited to): fines, suspension, loss of patron seniority and/or cancellation of patronship (and the associated benefits).



2025 **SPORT HORSE NATIONALS**

FACILITY MAP

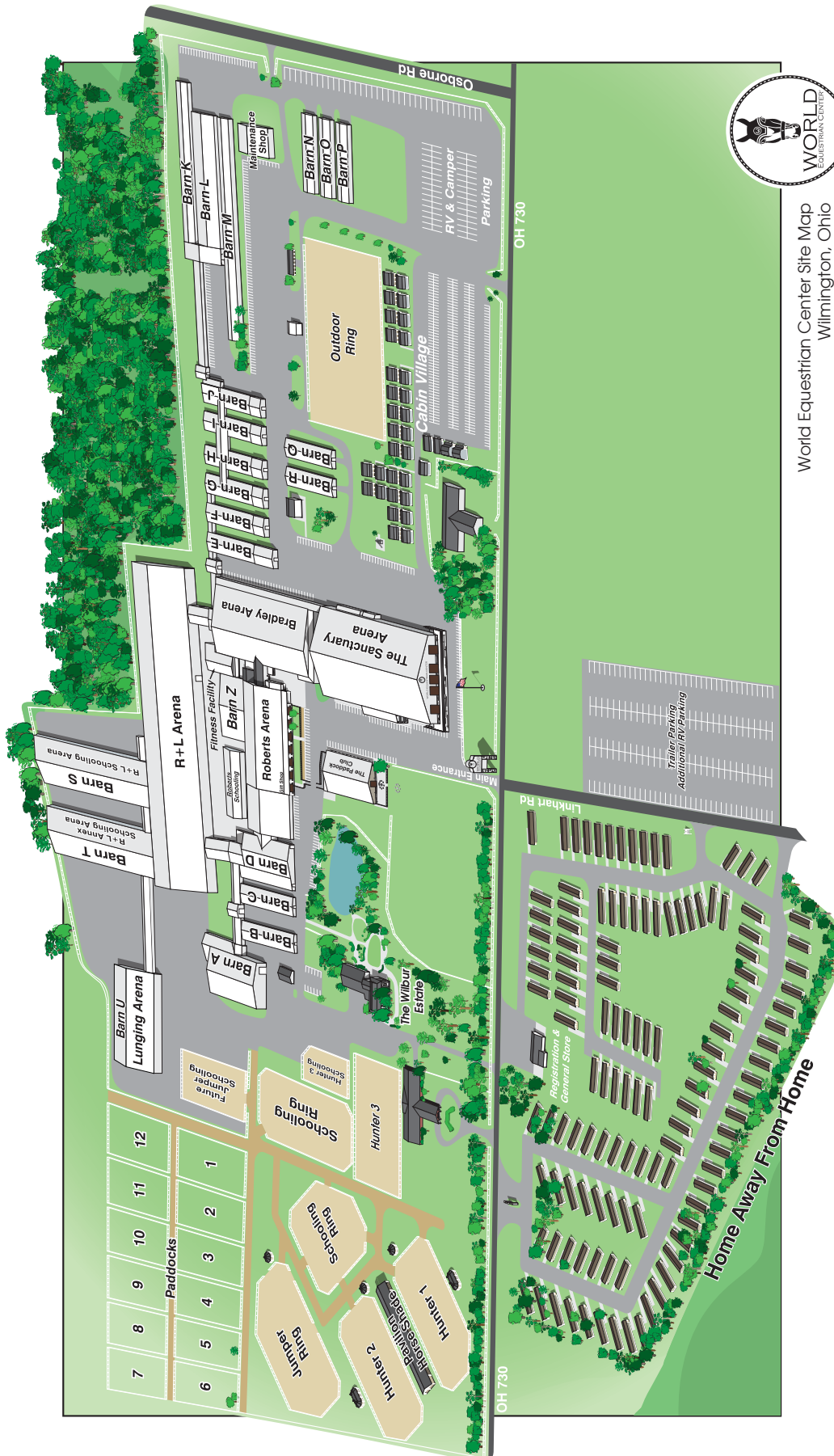

World Equestrian Center Site Map
Wilmington, Ohio



HOTELS

WORLD EQUESTRIAN CENTER LODGING

(937) 382-0985

HAMPTON INN & SUITES

201 Holiday Drive
Wilmington, OH 45177
(855) 271-3622

HOLIDAY INN WILMINGTON

123 Gano Road
Wilmington, OH 45177
(877) 895-5095

HOLIDAY INN EXPRESS

155 Holiday Drive
Wilmington, OH 45177
(877) 859-5095

WILMINGTON INN

909 Fife Avenue
Wilmington, OH 45177
(844) 382-3689

*Book early and mention you are with the Arabian Horse Association block.
Visit the Event Page at ArabianHorses.org to book online.*

VENDORS

FARRIER

Joe Proby
(708) 673-9692

GOLF CARTS

World Equestrian Center
(937) 382-0985

VETERINARIAN

**Equine Athlete
Veterinary Services**
12630 Merrill Rd
Pilot Point, TX 76258
(940) 686-0112

EMT

World Equestrian Center

PHOTOGRAPHER

Liz Crawley
www.lizcrawleyphotography.com

WEBSTREAMING

USEF Network

FEED & BEDDING

Must be purchased thru the
show office

Information subject to change before show dates. Visit the Event Page at ArabianHorses.org for updates.

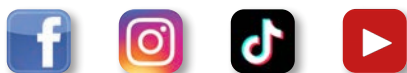

For updates & event news follow us on the **AHA APP**

Facebook @Arabian Horse Association

Instagram @arabianhorseassoc

TikTok @arabianhorseassoc

YouTube @aha10805

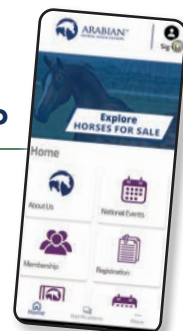

ADVERTISE IN OUR SHOW PROGRAMS!



*Take Center Stage—Advertise in Our Show
Programs and Captivate Every Audience!*

YOUTH & MID SUMMER

Full Page \$500

Half Ad \$250

(Vertical or Horizontal)

2 Page Spread \$975

Business Card Ad \$85/Card

SPORT HORSE NATIONALS

Full Page \$400

Half Ad \$200

(Vertical or Horizontal)

2 Page Spread \$775

Business Card Ad \$75/Card

DISTANCE NATIONALS

Full Page \$200

Half Ad \$100

(Vertical or Horizontal)

2 Page Spread \$375

Business Card Ad \$30/Card

U.S. NATIONALS

Full Page \$600

Half Ad \$325

(Vertical or Horizontal)

2 Page Spread \$1175

Business Card Ad \$100/Card

***NOW OFFERING 50% OFF ADS FOR AHA CLUBS,
REGIONS & SANCTIONED HORSE SHOWS.***

CALL NOW!



303.696.4551



marketing@arabianhorses.org

See Green IN 2025!

SPORT HORSE NATIONALS

BE SURE YOUR HORSE CAN PARTICIPATE IN THE SWEEPSTAKES DESIGNATED CLASSES AT SPORT HORSE NATIONALS. ENROLL YOUR 2026 FOAL AS A BREEDING ENTRY. THIS IS THE ONLY WAY TO ENROLL A HORSE IN THE SWEEPSTAKES PROGRAM TO BE ELIGIBLE TO EARN PRIZE MONEY.

THE BREEDER/NOMINATOR OF A BREEDING ENTRY CAN RECEIVE 15% OF ALL ALLOCATED PRIZE MONEY EARNED BY THAT ENTRY AT THE REGIONAL AND NATIONAL EVENTS PROVIDED ALL SWEEPSTAKES REQUIREMENTS ARE MET.



ARABIAN
BREEDERS SWEEPSTAKES

JOIN THE **GREEN** MOVEMENT
#AHASWEEPS

PHOTO BY JEFF JANSON



ARABIAN HORSE ASSOCIATION

Sweepstakes



Performance
Futurity/Maturity
Arabian Horse Association



ARABIAN HORSE ASSOCIATION

Performance Futurity/Maturity/Derby

ANYONE CAN DREAM - ANYONE CAN WIN / #DREAMBIGWINBIG

[ArabianHorses.org/competition/prize-money-programs/performance/](https://arabianhorses.org/competition/prize-money-programs/performance/)

ANYONE CAN DREAM— ANYONE CAN WIN

THE IN'S & OUT'S TO THE SPORT HORSE NATIONALS PERFORMANCE MATURITY PROGRAM

REMEMBER!

There are **3 steps to participating** in the Performance Maturity classes at Sport Horse Nationals:

1. Enrollment into the Performance Maturity Program
2. Entry into the corresponding Performance Maturity class at Sport Horse Nationals
3. All Half-Arabians competing in the Maturity Classes must have parentage DNA verified to a purebred Arabian parent on file at the AHA office in order to be eligible to compete in the class.

Owners wishing to compete in this program must enroll in the program either by making payments or one lump sum.

If enrollment is made in payments, the 2025 due dates are:

- **May 1st**
- **June 1st**
- **July 1st**

Late fees apply for any missed due dates.

Enrollments postmarked/electronic transaction dated after the first of May, June and July will be assessed late fees.

Nominations are allowed with the additional \$750 late fee up until the First Post Entry Close date for Sport Horse Nationals. Any Program enrollment fees (including late fees) must be paid.

In addition to the program enrollment, you must enter into the Performance Maturity Class at Sport Horse Nationals on an official entry form or online at the AHA website by the date of entry close. If you do not enter the show or program, a late fee(s) will be assessed.

Avoid Late Fees! Enroll & Enter on Time!



IT PAYS TO PLAY >>> SWEEPSTAKES

\$107,500 PRIZE MONEY

SWEEPSTAKES CLASSES AT SPORT HORSE NATIONALS!!!

YEARLING CLASSES

Restricted to Breeding Entries

- ABS Arabian Yearling Sport Horse Colt/Gelding (Class 1023)
- ABS Arabian Yearling Sport Horse Filly (Class 1022)
- ABS HA/AA Yearling Sport Horse Colt/Gelding (Class 1025)
- ABS HA/AA Yearling Sport Horse Filly (Class 1024)

CHAMPION – \$2,500

RESERVE CHAMPION – \$1,500

REMAINING TOP TEN – \$750

Horses enrolled as a Breeding Entry or Original Entry are eligible for Prize Money for the following classes:

**2 YEAR OLD CLASSES

- Arabian 2 Year Old Sport Horse Colt In-Hand (Class 599)
- Arabian 2 Year Old Gelding In-Hand (Class 600)
- Arabian 2 Year Old Filly In-Hand (Class 601)
- HA/AA 2 Year Old Sport Horse Colt/Gelding In-Hand (Class 1331)
- HA/AA 2 Year Old Sport Horse Filly In-Hand (Class 604)

CHAMPION – \$400

RESERVE CHAMPION – \$300

REMAINING TOP TEN – \$100

****If fewer than nineteen horses are in the class, 50% rounded up will be eligible for prize money.**

The following Classes are restricted to horses enrolled as a Breeding Entry or Original Entry:

- ABS Dressage Prospect Incentive (Class 1504)

CHAMPION – \$4,000

RESERVE CHAMPION – \$3,000

TOP TEN – \$1,000

- ABS Green Working Hunter Derby (Class 1520)

CHAMPION – \$4,000

RESERVE CHAMPION – \$3,000

TOP TEN – \$1,000

JACKPOT CLASSES

Restricted to Horses enrolled as a Breeding or Original Entry

- ★ ABS Arabian Sport Horse Under Saddle AOTR Jackpot (Class 1505)
- ★ ABS HA/AA Sport Horse Under Saddle AOTR Jackpot (Class 1506)

Restricted to horses that are enrolled as a Breeding or Original Entry and are 7 years of age and older. The Arabian Breeders Sweepstakes will add \$1,000 per entered and shown horse up to \$15,000 per class. Any jackpot money not distributed will be equally divided among all placings. Sweepstakes prize money not awarded will be retained in the Sweepstakes principal fund.

These classes are exempt from the 50% rule. Sweepstakes and Jackpot money will be awarded:

CHAMPION – 20%

RESERVE CHAMPION – 10%

REMAINING TOP TEN – 8.75%



ARABIAN
BREEDERS SWEEPSTAKES

JOIN THE GREEN MOVEMENT

USDF Membership Benefits: USDF is dedicated to education, the recognition of achievement, and promotion of dressage. For details on member benefits, including educational programs, awards, and other opportunities, refer to the *USDF Member Guide* or the USDF website at www.usdf.org.

**This
competition
is recognized
by USDF
for 2025**

Membership Requirements for USEF-licensed/USDF-recognized Competitions: Owners and riders, including foreign riders and owners who are not residents of the US, wishing to participate in a USEF-licensed/USDF-recognized competition as a rider or owner/lessee, must have either a USDF Group Membership (GM), Participating Membership (PM), or have a USDF Non-Member (NM) identification number and pay the USDF Non-Member (NM) fee. (Note: USDF Business Members can own horses but cannot compete as riders with their USDF Business Membership.)

Horses competing at USEF-licensed/USDF-recognized competitions must have either a USDF Horse Identification (HID) number or a USDF Lifetime Horse Registration (LHR). Proper credentials or verification certificates must be presented to the competition secretary.

Riders and owners wishing to participate in a USEF-licensed/USDF-recognized competition, and not able to present the competition secretary with verification of a USDF membership or NM identification, and USDF LHR or USDF HID, must complete a USDF Competition Affidavit Form and pay the \$5 affidavit filing fee. A copy of a completed affidavit form from another competition may also be used for verification purposes for up to 60 days. (Exception: Affidavits cannot be used at Great American Insurance Group/USDF Regional Dressage Championships.)

Exceptions:

- Horses competing only in Individual Breed Classes (IBCs) at DSHB competitions, sires and dams of horses in DSHB group classes, where those sires or dams are not actually competing in the same competition, horses competing only in breed restricted dressage or DSHB classes at Regular Competitions (e.g. all Arabian, all Friesian, or all Morgan classes), or in USDF Introductory Level tests, pas de deux or quadrille, are exempt from this requirement. Also exempt are horses ridden in leadline, exhibitions, games and races, classes for 4-H members, walk-trot, academy, and opportunity classes.
- Riders and owners/lessees competing only in classes which are exempt from the USDF HID requirements are also exempt from the USDF NM identification number and NM fee requirements. Also exempt are handlers of horses competing in DSHB In-Hand or Group classes.

Memberships Defined

Participating Membership (PM): A membership issued to an individual directly by USDF. The membership year is December 1 through November 30. PMs are available for 1-year (\$100), 5-years (\$400), or life (\$2,000). A USDF Youth Participating Membership (YPM) is available for individuals who have not reached their 21st birthday by December 1 of the current membership year (\$80). A PM allows the member to compete at USEF-licensed/USDF-recognized competitions and to participate as a rider and/or owner/lessee for all Adequan®/USDF Year-End Awards and the Great American Insurance Group/USDF Regional Dressage Championship program.

Group Membership (GM): A membership issued to an individual by USDF when the member name and dues are submitted to USDF through an affiliate Group Member Organization (GMO). The GM year begins December 1 and ends November 30. A GM allows the member to compete at USEF-licensed/USDF-recognized competitions and participate in the USDF Rider Awards Program.

Business Membership (BM): A membership that runs December 1 through November 30 and is issued to a business or organization directly by USDF. The USDF BM (\$280) offers a wider variety of advertising benefits. BMs satisfy requirements of horse ownership only.

Non-Member (NM) Identification Number: For each USDF NM owner/lessee and USDF NM rider there will be a USDF NM fee of \$55 per competition that must be collected by the show secretary and submitted to USDF, along with the USDF Report of Fees document and the \$5 affidavit fee and Competition Affidavit Form if the person cannot provide a copy of their USDF NM card. Owners/lessees or riders exempt from the NM number requirements are also exempt from paying the USDF NM fee. If there are multiple owners of a horse and all are NMs, only one of the owners must pay the NM fee. If the horse has at least one owner who is a current USDF PM, GM, or BM there is no NM fee assessed. Competition management will be invoiced for all applicable USDF NM fees not received with the USDF post-competition paperwork, along with a report listing all USDF NMs. Competition management is then required to submit the NM fees within 30 days to the USDF. An individual with a USDF NM identification number is not eligible for any USDF membership benefits. Once a USDF NM number has been assigned, a USDF NM card can be obtained from the USDF website.

Horse Identification (HID) Number: A one-time tracking number for horses (\$45). Scores earned by a horse with an HID number will be recorded but will NOT be counted towards Adequan®/USDF Year-End Awards. A horse with an HID number is not eligible to compete in Great American Insurance Group/USDF Regional qualifying or championship classes. An HID number can be upgraded to a Lifetime Horse Registration (LHR) for a fee of \$95. If a horse has a USDF LHR it does not need an HID number. An HID number is a one-time fee that does not need to be renewed.

Lifetime Horse Registration (LHR): A horse with an LHR (\$140) is eligible for Adequan®/USDF Year-End Awards, and eligible to compete in Great American Insurance Group/USDF Regional qualifying and championship classes, assuming requirements for the owner and rider are met. If a horse has an LHR it does not need an HID number. An LHR does not need to be renewed.

How to Join USDF

Applications for USDF Participating Membership (PM), Business Membership (BM), Horse Identification (HID) number, and Lifetime Horse Registration (LHR) may be found in the following locations:

- On the USDF website: www.usdf.org. You can submit the application online or download the form.
- In the show office at USEF-licensed/USDF-recognized competitions classified by USEF as Dressage Competitions, and Regular Competitions which are open to all breeds.
- By calling or writing the USDF office at (859) 971-2277, 4051 Iron Works Parkway, Lexington, KY 40511

The effective date of membership is the date the form and correct fees are received in the USDF office or, if applying at a competition, the date accepted by the competition secretary, provided the application is signed and dated by the competition secretary, member, and/or horse owner on that same day.